



ARMOUR
ANALYTICAL SERVICES

Project Number 2481

**Management
Asbestos Survey Report**

Kingswood Platoon, Bristol, BS15 4RF



Working in Partnership with Shield Environmental Services



Document Name	Author	Issued by	Revision Number	Issue Date	Page No
2019	David Kelly	Armour AS	0	24/09/2019	1

Contents

Section	
1	Contacts & Authorisation
2	Executive Summary
3	Site Description & Survey Information
4	Positive and Presumed Photos Sheets
5	Negative Photos Sheets
6	Survey Objectives
7	Survey Techniques
8	Survey Caveat
9	Survey Notes
10	Material Assessment Algorithm
11	Certificates of Bulk Analysis
12	Site Plan

Document Name	Author	Issued by	Revision Number	Issue Date	Page No
2019	David Kelly	Armour AS	0	24/09/2019	2



Section 1: Contact Details

Client Details:		Instructing Party:	
Wessex RFCA Mount House Mount Street Taunton TA1 3QE		Shield Environmental Shield House Caxton Business Park Crown Way Bristol BS30 8XJ	
Contact Name:	Sue Morrell	Contact Name:	Chloe Smith
Tel: 01823250115	Fax: N/A	Tel: 01173012650	Fax: N/A

Site Address:		Report Author:	
Kingswood Platoon Bristol BS15 4RF		Armour Analytical Services Admirals Yard Station Road Bristol BS34 6LR	
Contact Name:	Gary Forder	Contact Name:	David Kelly
Tel: 07850024689	Fax: N/A	Mobile: 07769707519	

Lead Surveyor's Name:	Lead Surveyor's Authorising Signature:
D. Kelly	

Document Name	Author	Issued by	Revision Number	Issue Date	Page No
2019	David Kelly	Armour AS	0	24/09/2019	3

Section 2: Executive Summary

Sample Number	Sample Type	Location	Analysis
DK/1	Toilet Cisterns	WC's X 2	Amosite
DK/2	Sink Pad	Kitchen	Chrysotile
DK/3	Insulation Board Panels	Offices X 2	Chrysotile Amosite
DK/4	Damp Proof Course	External	N.A.D.I.S

N.A.D.I.S – No Asbestos Detected in Sample

A.D – Asbestos Detected

The following items have been Presumed to be Asbestos Containing Materials as they were not accessible at the time of the survey:

Item 9 – Range – No Access

The presence of asbestos in these areas cannot be ascertained at this time. If any works are to be carried out in these areas in the future, then these works should be approached cautiously.

In accordance with current legislation, any suspect materials encountered in these areas are to be assumed to contain asbestos until proven otherwise. This will normally involve cessation of works in the affected area.

Document Name	Author	Issued by	Revision Number	Issue Date	Page No
2019	David Kelly	Armour AS	0	24/09/2019	4

Section 3: Site Description & Survey Information

Brief description on the general building construction

Timber frame construction with a pitched metal profiled roof.

Caveat for no access areas

All areas were accessible at the time of survey.

EXTERNAL MATERIALS

Roof Type	Pitched
Roof Materials	Profiled Metal
Soffits	Timber
Fascia	Metal
Walls	Timber, Brick
Verge Under cloaking	N/A
Guttering	Plastic
Downpipes	Plastic
Window/Door frames	UPVC/Timber
Other Materials	N/A

INTERNAL MATERIALS

Loft Insulation	Fiberglass
Roof Underlining	N/A
Ceilings	Plasterboard
Walls <i>Internal</i>	Plasterboard
Floors	Timber, Lino
Doors/Frames	Timber
Pipework/Insulation	N/A
Boxings	N/A
Boiler Make	N/A
Flue Pipes	N/A
Storage Heaters	Non asbestos electric heaters
Electrical Boxes/Machinery	Modern boxes
Ducting/Risers	N/A
Stairs	N/A
Lift Shafts	N/A
Other Materials	N/A

Document Name	Author	Issued by	Revision Number	Issue Date	Page No
2019	David Kelly	Armour AS	0	24/09/2019	5



Section 4: Positive and Presumed Photos Sheets

Item No: 1

Sample No: DK/1

Location: Ground Floor – WC's x 2

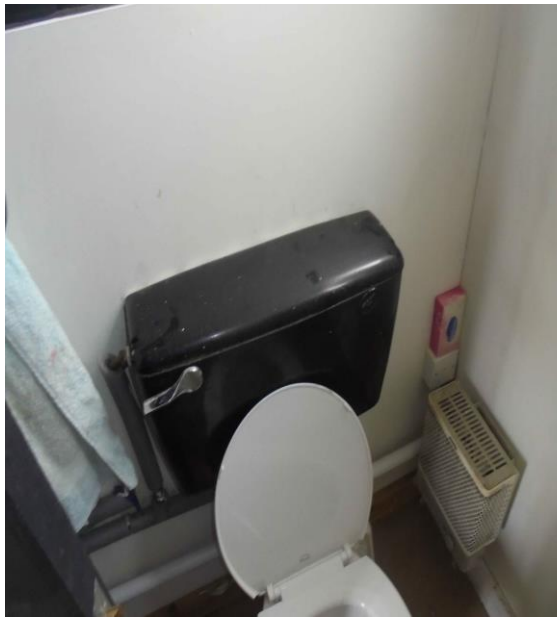

Material Description:	Toilet Cisterns & Seat	
Identification:	Sampled – Asbestos Detected	
Approx. quantity:	2 x Cisterns, 1 x Seat	
Accessibility	High	<i>Assessment Score</i>
Product type:	Composite	1
Extent of Damage:	Minor	1
Surface Treatment:	Non-Friable	0
Asbestos type:	Amosite	2
Material Assessment Score:		4
Priority Assessment Score:		Negligible
Action:	Manage	
Comments:	N/A	

Document Name	Author	Issued by	Revision Number	Issue Date	Page No
2019	David Kelly	Armour AS	0	24/09/2019	6



Item No: 2

Sample No: DK/2

Location: Ground Floor - Kitchen



Material Description:	Sink Pad	
Identification:	Sampled – Asbestos Detected	
Approx. quantity:	1 x Sink	
Accessibility	Low	<i>Assessment Score</i>
Product type:	Bitumen	1
Extent of Damage:	Minor	1
Surface Treatment:	Non-Friable	0
Asbestos type:	Chrysotile	1
Material Assessment Score:		3
Priority Assessment Score:		Negligible
Action:	Manage	
Comments:	N/A	

Document Name	Author	Issued by	Revision Number	Issue Date	Page No
2019	David Kelly	Armour AS	0	24/09/2019	7



Item No: 4

Sample No: DK/3

Location: Ground Floor – Offices x 2



Material Description:	Insulation Board Panels on Ceiling	
Identification:	Sampled – Asbestos Detected	
Approx. quantity:	2 x Panels (2M2 Total)	
Accessibility	Low	Assessment Score
Product type:	Insulation Board	2
Extent of Damage:	Minor	1
Surface Treatment:	Sealed	1
Asbestos type:	Chrysotile/Amosite	2
Material Assessment Score:		6
Priority Assessment Score:		Low
Action:	Manage	
Comments:	N/A	

Document Name	Author	Issued by	Revision Number	Issue Date	Page No
2019	David Kelly	Armour AS	0	24/09/2019	8

**Item No: 7****Sample No: N/A****Location: Ground Floor – Parade Hall**

Material Description:	Insulation Board Panels on Ceiling	
Identification:	As per Sample DK/3 – Asbestos Detected	
Approx. quantity:	4 x Panels (3M2 Total)	
Accessibility	Low	<i>Assessment Score</i>
Product type:	Insulation Board	2
Extent of Damage:	Moderate	2
Surface Treatment:	Sealed	1
Asbestos type:	Chrysotile/Amosite	2
Material Assessment Score:		7
Priority Assessment Score:		Medium
Action:	Encapsulate	
Comments:	Damage to corner of panel nearest the server hatch.	

Document Name	Author	Issued by	Revision Number	Issue Date	Page No
2019	David Kelly	Armour AS	0	24/09/2019	9



Item No: 8

Sample No: N/A

Location: Ground Floor – Lecture Rooms x 2



Material Description:	Insulation Board Panels on Ceiling	
Identification:	As per Sample DK/3 – Asbestos Detected	
Approx. quantity:	4 x Panels (3M2 Total)	
Accessibility	Low	Assessment Score
Product type:	Insulation Board	2
Extent of Damage:	Minor	1
Surface Treatment:	Sealed	1
Asbestos type:	Chrysotile/Amosite	2
Material Assessment Score:		6
Priority Assessment Score:		Low
Action:	Manage	
Comments:	N/A	

Document Name	Author	Issued by	Revision Number	Issue Date	Page No
2019	David Kelly	Armour AS	0	24/09/2019	10

**Item No: 9****Sample No: N/A****Location: Ground Floor – Range**

Material Description:	No Access within Range	
Identification:	Presumed to Contain Asbestos	
Approx. quantity:	Unknown	
Accessibility	Low	<i>Assessment Score</i>
Product type:	No Access	3
Extent of Damage:	No Access	3
Surface Treatment:	No Access	3
Asbestos type:	No Access	3
Material Assessment Score:		12
Priority Assessment Score:		High
Action:	Further Investigation Required/Restrict Access	
Comments:	No access within range as hatch screwed shut. Site contact stated that asbestos cement was once stored within the range and although it has been removed, it is likely that debris remains	

Document Name	Author	Issued by	Revision Number	Issue Date	Page No
2019	David Kelly	Armour AS	0	24/09/2019	11

Section 5: Negative Photos Sheets

Item No: 3

Sample No: N/A

Location: Ground Floor – Lobby/Corridor



Material Description:	Visual Inspection – No Suspect Materials Found	
Identification:	N/A	
Approx. quantity:	N/A	
Accessibility	N/A	<i>Assessment Score</i>
Product type:		N/A
Extent of Damage:		N/A
Surface Treatment:		N/A
Asbestos type:		N/A
Material Assessment Score:		N/A
Priority Assessment Score:		N/A
Action:	N/A	
Comments:	Modern Electrics	

Document Name	Author	Issued by	Revision Number	Issue Date	Page No
2019	David Kelly	Armour AS	0	24/09/2019	12



Item No: 5

Sample No: N/A

Location: Ground Floor – Store



Material Description:	Visual Inspection – No Suspect Materials Found	
Identification:	N/A	
Approx. quantity:	N/A	
Accessibility	N/A	<i>Assessment Score</i>
Product type:		N/A
Extent of Damage:		N/A
Surface Treatment:		N/A
Asbestos type:		N/A
Material Assessment Score:		N/A
Priority Assessment Score:		N/A
Action:	N/A	
Comments:	N/A	

Document Name	Author	Issued by	Revision Number	Issue Date	Page No
2019	David Kelly	Armour AS	0	24/09/2019	13



Item No: 6

Sample No: N/A

Location: Ground Floor – Loft Space



Material Description:	Visual Inspection – No Suspect Materials Found	
Identification:	N/A	
Approx. quantity:	N/A	
Accessibility	N/A	<i>Assessment Score</i>
Product type:		N/A
Extent of Damage:		N/A
Surface Treatment:		N/A
Asbestos type:		N/A
Material Assessment Score:		N/A
Priority Assessment Score:		N/A
Action:	N/A	
Comments:	N/A	

Document Name	Author	Issued by	Revision Number	Issue Date	Page No
2019	David Kelly	Armour AS	0	24/09/2019	14



Item No: 10

Sample No: DK/4

Location: External



Material Description:	Damp Proof Course	
Identification:	Sampled – No Asbestos Detected	
Approx. quantity:	To Entire Perimeter of Building	
Accessibility	N/A	<i>Assessment Score</i>
Product type:		N/A
Extent of Damage:		N/A
Surface Treatment:		N/A
Asbestos type:		N/A
Material Assessment Score:		N/A
Priority Assessment Score:		N/A
Action:	N/A	
Comments:	N/A	

Document Name	Author	Issued by	Revision Number	Issue Date	Page No
2019	David Kelly	Armour AS	0	24/09/2019	15

Section 6: Survey Objectives

Instructions were received from Sue Morrell of Wessex RFCA carry out a Management asbestos survey at Kingswood Platoon, Bristol, BS15 4RF in accordance with HSG264 and Armour Analytical's quality procedures.

The survey was carried out on 2nd August 2019 by David Kelly with the objective of facilitating a Management report.

This Management survey is characterised as a 'Visual Inspection Sampling and Identification Survey' in HSG264. This type of survey is used to locate and describe, so far as is reasonably practicable, all asbestos containing materials (ACMs) in the building and will by its nature involve the partial destruction of the building's fabric as access is gained to all areas. A full sampling programme is undertaken to identify possible ACMs and estimate the extent of ACMs reported.

The objective of this survey report is to identify, so far as is reasonably practicable, the location, extent, product type and composition of ACMS within the building to enable the building occupants to put management and remedial procedures in place.

Document Name	Author	Issued by	Revision Number	Issue Date	Page No
2019	David Kelly	Armour AS	0	24/09/2019	16

Section 7: Survey Techniques

Each floor, room and area within the scope was systematically inspected for suspect materials thought or known to contain asbestos and where such materials were encountered their location, extent, and composition were recorded.

Where materials of a similar nature exist, to those previously sampled, and a reasoned argument can be made that their composition is likely to be identical further physical sampling was not undertaken.

Photographs were taken of all sample locations, unless otherwise stated.

The analysis of suspect ACMs was undertaken by a UKAS accredited laboratory using the analytical method detailed in *HSG248, Appendix 2 -Asbestos: The analysts' guide for sampling, analysis and clearance procedures*.

Document Name	Author	Issued by	Revision Number	Issue Date	Page No
2019	David Kelly	Armour AS	0	24/09/2019	17

Section 8: Survey Caveat

This report is based upon a management report inspection of an unfamiliar site. During the course of the survey all reasonable efforts were made to identify the physical presence of materials containing asbestos within the building.

A Management Survey is a non-intrusive survey, meaning that access within the fabric of the building is limited. The survey does not include access to the following areas (unless agreed beforehand with the Client and provisions are put in place):

- Within wall or ceiling construction;
- Under fixed flooring;
- Within non-openable boxings;
- Within live electrics, boilers or machinery;
- Where access/visibility is limited in an area due to stored items, furniture or services;
- Areas where there is no safe access to inspect such as floor ducts, lift shafts and loft spaces with no crawlboards;
- High level areas that are too high to safely inspect.
- Within pipework insulation throughout building as this would affect the integrity of services.

Any intrusive works carried out within the building must first be subject to a Refurbishment Asbestos Survey.

This report will be restricted to the areas that fall within the scope of works for project and will not take into account any area's that do not fall within the scope. Any asbestos that is identified within this report will need to be added to the buildings existing information and should not form the basis for a management survey. This survey will not include priority assessments nor will it include a register.

This survey considered the construction of the building, associated fixtures & fittings and associated structures and in no way should it be considered as a ground investigation report.

Services should be disconnected prior to commencement of a Management survey; however, where plant and/or electrical installations are live or appear to be live then these will not be accessed.

This survey report is not a bill of quantities.

Document Name	Author	Issued by	Revision Number	Issue Date	Page No
2019	David Kelly	Armour AS	0	24/09/2019	18

Section 9: Survey Notes

This report has been written with reference to the various Guidance Notes etc, issued, and current at the date of this report and describes circumstances at the site on the date the investigation took place.

Where similar items exist in the building, only one or two samples have been taken to ascertain the material content. It was assumed that similar products were of the same material.

Any person undertaking work within the buildings should be told of the presence of asbestos. This briefing also applies to any other person associated with the site, including staff, sub-contractors and others.

The drawings in the report are not to scale and are illustrative only to indicate approximate locations. The descriptions used are for location identification purposes.

All the recommendations described in this report are based upon assumptions made after consideration of the type of material, condition of the material, its location, analysis result and type of use the area is thought to be subjected to. However, statutory authorities or others could require amendments based on local knowledge, change in legislation, change in use or indeed other conditions or criteria.

Samples taken from floor tiles (or similar material) may include a bitumen adhesive as part of the sample. It is known that some proprietary brands of bitumen have an asbestos content and this will be included as an integral part of the bulk sample unless otherwise stated.

Document Name	Author	Issued by	Revision Number	Issue Date	Page No
2019	David Kelly	Armour AS	0	24/09/2019	19

Section 10: Material Assessment Algorithm

Variable	Score	Examples
Installation / Product type	1	Vinyl, 'Bakelite', Cement
	2	Asbestos insulating board, paper, rope
	3	Pipe insulation, spray coating, friable debris
Condition / damage	0	Good
	1	Slight / minor damage
	2	Moderate damage – breakage to surface treatment
	3	Major damage – smashed or exposed material
Surface treatment	0	Non-friable e.g. vinyl
	1	Enclosed insulation, encapsulated AIB
	2	Unsealed AIB, encapsulated insulation
	3	Unsealed insulation or spray coating
Asbestos type	1	Chrysotile
	2	Amosite & other amphiboles
	3	Crocidolite

The scores from each of the four sections are added together to produce a risk score:

Risk score	Risk assessment
10 or more	High risk
7 – 9	Medium risk
5 – 6	Low risk
4 & below	Negligible risk

Document Name	Author	Issued by	Revision Number	Issue Date	Page No
2019	David Kelly	Armour AS	0	24/09/2019	20



Section 11: Certificates of Bulk Analysis



Our Ref: J172853 FI: 4
Your Ref: 2481
Date: 07/08/2019

ENVIROCHEM
Analytical Laboratories Ltd.
12 The Gardens
Broadcut, Fareham
Hampshire
PO16 8SS



Tel: (01329) 287777
Fax: (01329) 287755
www.envirochem.co.uk
office@envirochem.co.uk

Asbestos Fibre Identification Report

Client: Armour Analytical Services Ltd
Admirals Yard, Station Road, Patchway, Bristol, BS34 6LR
Site Address: Kingswood Platoon, Bristol, BS15 4RF
Sampled By: Armour Analytical Services Ltd
Date sampled/received: 6th August 2019
Date analysed: 7th August 2019
Analyst/s: Raphael Mirzaians
Analysis Location: 12 The Gardens, Broadcut, Fareham, Hampshire, PO16 8SS

ANALYTICAL PROCEDURE

Fibre identification was carried out in accordance with the documented 'in-house' methods based on the HSE Guidance Note HSG 248. These employed stereo microscopy, polarized microscopy and dispersion staining techniques.

RESULTS

Sample No.	Sample Ref.	Location	Asbestos Detected	Asbestos Type
DK/1	BS567574	WC's x 2 - Toilet cisterns	Yes	Amosite
DK/2	BS567575	Kitchen - Sink pad	Yes	Chrysotile
DK/3	BS567576	Offices x 2 - Insulation board panels	Yes	Chrysotile Amosite
DK/4	BS567577	External - Damp proof course	No	

NOTES

1. Samples were examined for the presence of 6 types of asbestos fibres: amosite (brown), crocidolite (blue), chrysotile (white), actinolite (white), anthophyllite (white) and tremolite (white).
2. Samples collected by the client are evaluated using information provided by the client. For samples collected by the client the date of receipt is deemed to be the same as the date sampled.
3. Re-analysis is a UKAS accredited laboratory for sampling and identification of asbestos containing materials.
4. Chemical, observational and optical are outside the scope of UKAS accreditation.
5. The analytical method in the HSG248 does not quantify the amount of asbestos present, therefore UKAS accreditation does not permit quantification.
6. If, during fibre identification, only 1 or 2 fibres are seen and identified as asbestos, then the term 'trace asbestos identified' is used.

SIGNATURE:

Authorised signatory

PRINT NAME: Raphael Mirzaians





Reg. No. 2378228 England. Registered Office: Envirochem, 12 The Gardens, Broadcut, Fareham, Hampshire, PO16 8SS.

Page 1 of 1

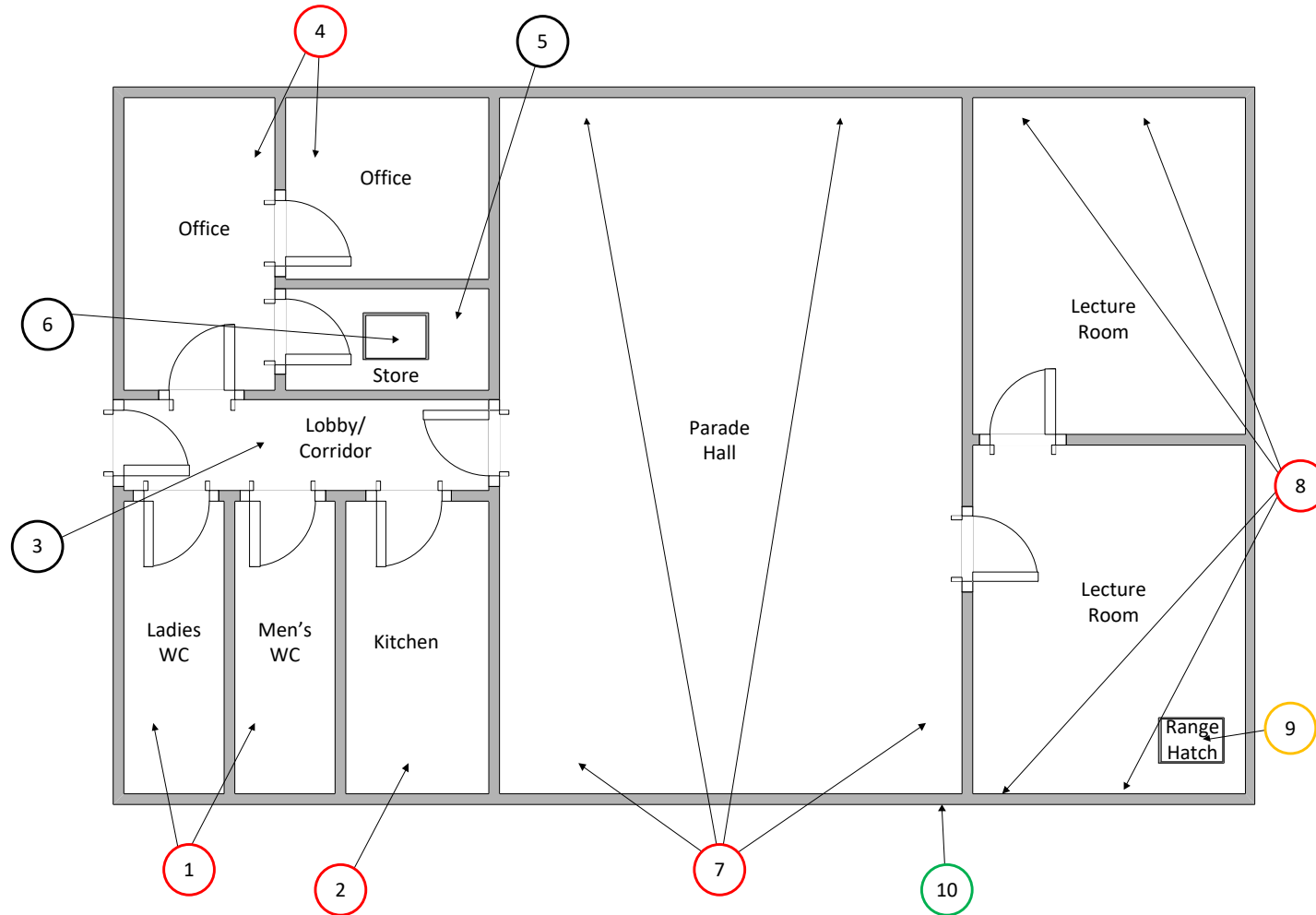
Document Name	Author	Issued by	Revision Number	Issue Date	Page No
2019	David Kelly	Armour AS	0	24/09/2019	21

Section 12: Site Plan



KEY	
	Visual Inspection
	ACM's Detected (Positive Items)
	No ACM's Detected (Negative Items)
	Presumed to Contain ACM's
	No Access

Document Name	Author	Issued by	Revision Number	Issue Date	Page No
2019	David Kelly	Armour AS	0	24/09/2019	22



ARMOUR
ANALYTICAL SERVICES

I the surveyor can confirm that this report is accurate to my findings onsite and this survey has been Content checked by myself.

Checked by: David Kelly

Date: 23/09/2019

I the Admin Manager can confirm that this report is accurate to the paperwork received and this survey has been quality checked by myself.

Checked by: Emma Humphreys

Date: 24.09.2019

Report Compiled By

Armour Analytical Services Ltd, Admirals Yard, Station Road, Bristol, BS34 6LR

Document Name	Author	Issued by	Revision Number	Issue Date	Page No
2019	David Kelly	Armour AS	0	24/09/2019	23