



ARMOUR
ANALYTICAL SERVICES

Project Number 2481

**Management
Asbestos Survey Report**

**Looe Platoon, Sunrising Estate, Looe, Cornwall,
PL13 1NA**



Working in Partnership with Shield Environmental Services



Document Name	Author	Issued by	Revision Number	Issue Date	Page No
2019	Kacey Lillis	Armour AS	0	28/10/2019	1

Contents

Section	
1	Contacts & Authorisation
2	Executive Summary
3	Site Description & Survey Information
4	Positive and Presumed Photos Sheets
5	Negative Photos Sheets
6	Survey Objectives
7	Survey Techniques
8	Survey Caveat
9	Survey Notes
10	Material Assessment Algorithm
11	Certificates of Bulk Analysis
12	Site Plan

Document Name	Author	Issued by	Revision Number	Issue Date	Page No
2019	Kacey Lillis	Armour AS	0	28/10/2019	2



Section 1: Contact Details

Client Details:		Instructing Party:	
Wessex RFCA Mount House Mount Street Taunton TA1 3QE		Shield Environmental Shield House Caxton Business Park Crown Way Bristol BS30 8XJ	
Contact Name:	Sue Morrell	Contact Name:	Chloe Smith
Tel: 01823250115	Fax: N/A	Tel: 01173012650	Fax: N/A

Site Address:		Report Author:	
Looe Platoon, Sunrising Estate, Looe, Cornwall, PL13 1NA		Armour Analytical Services Admirals Yard Station Road Bristol BS34 6LR	
Contact Name:	Gary White	Contact Name:	Emma Humphreys
Tel: 07787558356	Fax: N/A	Mobile: 07468535836	

Lead Surveyor's Name:	Lead Surveyor's Authorising Signature:
D. Kelly	

Document Name	Author	Issued by	Revision Number	Issue Date	Page No
2019	Kacey Lillis	Armour AS	0	28/10/2019	3

Section 2: Executive Summary

Sample Number	Sample Type	Location	Analysis
DK/1	Floor Tiles	Kitchen and Lobby	N.A.D.I.S
DK/2	Insulation Board Panels on Ceiling	Drill Hall	N.A.D.I.S

N.A.D.I.S – No Asbestos Detected in Sample

Document Name	Author	Issued by	Revision Number	Issue Date	Page No
2019	Kacey Lillis	Armour AS	0	28/10/2019	4



Section 3: Site Description & Survey Information

Brief description on the general building construction

Timber Frame Construction with a Flat Roof and Modern Insulation Board Wall Cladding.

Caveat for no access areas

N/A

EXTERNAL MATERIALS

Roof Type	Flat
Roof Materials	Felt
Soffits	Timber
Fascia	Timber
Walls	Modern Insulation Board
Verge Under cloaking	N/A
Guttering	Plastic
Downpipes	Plastic
Window/Door frames	UPVC
Other Materials	N/A

INTERNAL MATERIALS

Loft Insulation	N/A
Roof Underlining	N/A
Ceilings	Plasterboard
Walls <i>Internal</i>	Plasterboard
Floors	Tiles, Lino, Timber
Doors/Frames	Timber
Pipework/Insulation	N/A
Boxings	Plasterboard
Boiler Make	N/A
Flue Pipes	N/A
Storage Heaters	Modern Heaters
Electrical Boxes/Machinery	Modern
Ducting/Risers	N/A
Stairs	N/A
Lift Shafts	N/A
Other Materials	N/A

Document Name	Author	Issued by	Revision Number	Issue Date	Page No
2019	Kacey Lillis	Armour AS	0	28/10/2019	5

Section 4: Positive and Presumed Photos Sheets

No positive or presumed items were found during this survey.

Document Name	Author	Issued by	Revision Number	Issue Date	Page No
2019	Kacey Lillis	Armour AS	0	28/10/2019	6



Section 5: Negative Photos Sheets

Item No: 1

Sample No: N/A

Location: Ground Floor – Office and Store



Material Description:	Visual Inspection – No Suspect Materials Found	
Identification:	N/A	
Approx. quantity:	N/A	
Accessibility	N/A	<i>Assessment Score</i>
Product type:	N/A	N/A
Extent of Damage:	N/A	N/A
Surface Treatment:	N/A	N/A
Asbestos type:	N/A	N/A
Material Assessment Score:		N/A
Priority Assessment Score:		N/A
Action:	N/A	
Comments:	N/A	

Document Name	Author	Issued by	Revision Number	Issue Date	Page No
2019	Kacey Lillis	Armour AS	0	28/10/2019	7



Item No: 2

Sample No: DK/1

Location: Ground Floor – Kitchen and Lobby



Material Description:	Floor Tiles	
Identification:	Sampled – No Asbestos Detected	
Approx. quantity:	12M2	
Accessibility	High	<i>Assessment Score</i>
Product type:	N/A	N/A
Extent of Damage:	N/A	N/A
Surface Treatment:	N/A	N/A
Asbestos type:	N/A	N/A
Material Assessment Score:		N/A
Priority Assessment Score:		N/A
Action:	N/A	
Comments:	Modern Sink Pad in Kitchen	

Document Name	Author	Issued by	Revision Number	Issue Date	Page No
2019	Kacey Lillis	Armour AS	0	28/10/2019	8



Item No: 3

Sample No: N/A

Location: Ground Floor - WC's X 2 and Cupboard

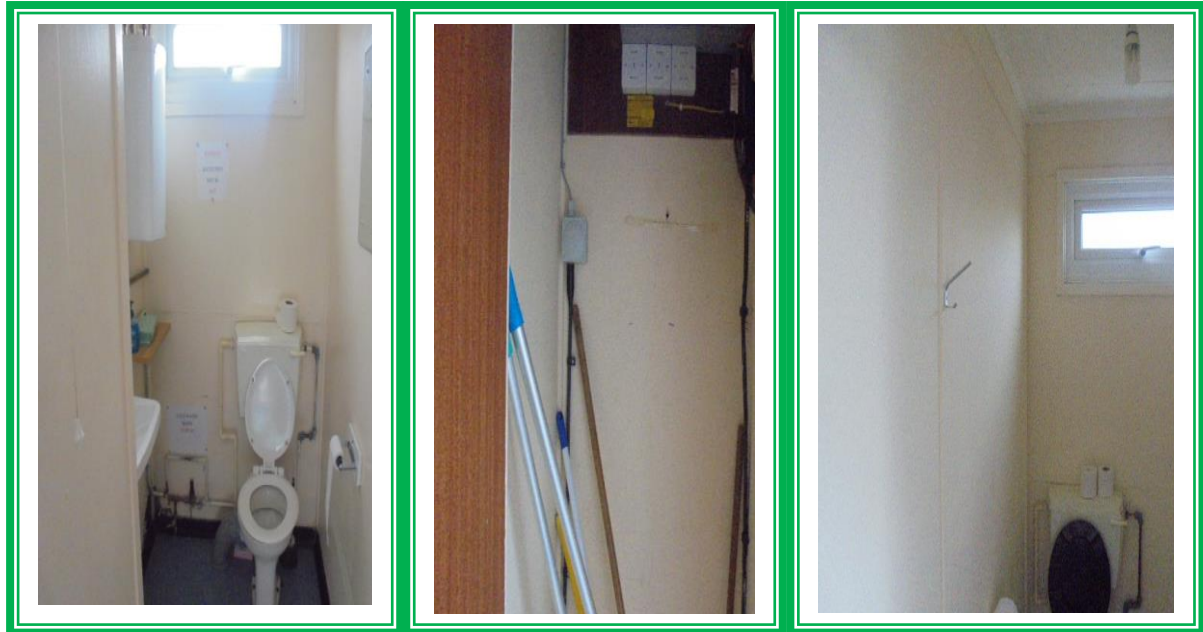

Material Description:	Visual Inspection – No Suspect Materials Found	
Identification:	N/A	
Approx. quantity:	N/A	
Accessibility	N/A	<i>Assessment Score</i>
Product type:	N/A	N/A
Extent of Damage:	N/A	N/A
Surface Treatment:	N/A	N/A
Asbestos type:	N/A	N/A
Material Assessment Score:		N/A
Priority Assessment Score:		N/A
Action:	N/A	
Comments:	Modern Toilet Seats, Flooring and Electrics	

Document Name	Author	Issued by	Revision Number	Issue Date	Page No
2019	Kacey Lillis	Armour AS	0	28/10/2019	9



Item No: 4

Sample No: DK/2

Location: Ground Floor - Drill Hall



Material Description:	Insulation Board Panels on Ceiling	
Identification:	Sampled – No Asbestos Detected	
Approx. quantity:	1-2M2 – Total (4 X Pads)	
Accessibility	Low	<i>Assessment Score</i>
Product type:	N/A	N/A
Extent of Damage:	N/A	N/A
Surface Treatment:	N/A	N/A
Asbestos type:	N/A	N/A
Material Assessment Score:		N/A
Priority Assessment Score:		N/A
Action:	N/A	
Comments:	N/A	

Document Name	Author	Issued by	Revision Number	Issue Date	Page No
2019	Kacey Lillis	Armour AS	0	28/10/2019	10



Item No: 5

Sample No: N/A

Location: Ground Floor - Classroom 1A and 1B



Material Description:	Insulation Board Panels on Ceiling	
Identification:	As Per Sample DK/2 – No Asbestos Detected	
Approx. quantity:	2 X Panels (1M2 Total)	
Accessibility	Low	<i>Assessment Score</i>
Product type:	N/A	N/A
Extent of Damage:	N/A	N/A
Surface Treatment:	N/A	N/A
Asbestos type:	N/A	N/A
Material Assessment Score:		N/A
Priority Assessment Score:		N/A
Action:	N/A	
Comments:	N/A	

Document Name	Author	Issued by	Revision Number	Issue Date	Page No
2019	Kacey Lillis	Armour AS	0	28/10/2019	11



Item No: 6

Sample No: N/A

Location: Ground Floor - Classroom 2



Material Description:	Insulation Board Panels on Ceiling	
Identification:	As Per Sample DK/2 – No Asbestos Detected	
Approx. quantity:	2 X Panels (1M2 Total)	
Accessibility	Low	Low
Product type:	N/A	N/A
Extent of Damage:	N/A	N/A
Surface Treatment:	N/A	N/A
Asbestos type:	N/A	N/A
Material Assessment Score:		N/A
Priority Assessment Score:		N/A
Action:	N/A	
Comments:	N/A	

Document Name	Author	Issued by	Revision Number	Issue Date	Page No
2019	Kacey Lillis	Armour AS	0	28/10/2019	12

Section 6: Survey Objectives

Instructions were received from Sue Morrell of Wessex RFCA to carry out a Management asbestos survey at Looe Platoon, Sunrising Estate, Looe, Cornwall PL13 1NA in accordance with HSG264 and Armour Analytical's quality procedures.

The survey was carried out on Tuesday 17th September 2019 by David Kelly with the objective of facilitating a Management report.

This Management survey is characterised as a 'Visual Inspection Sampling and Identification Survey' in HSG264. This type of survey is used to locate and describe, so far as is reasonably practicable, all asbestos containing materials (ACMs) in the building and will by its nature involve the partial destruction of the building's fabric as access is gained to all areas. A full sampling programme is undertaken to identify possible ACMs and estimate the extent of ACMs reported.

The objective of this survey report is to identify, so far as is reasonably practicable, the location, extent, product type and composition of ACMS within the building to enable the building occupants to put management and remedial procedures in place.

Document Name	Author	Issued by	Revision Number	Issue Date	Page No
2019	Kacey Lillis	Armour AS	0	28/10/2019	13

Section 7: Survey Techniques

Each floor, room and area within the scope was systematically inspected for suspect materials thought or known to contain asbestos and where such materials were encountered their location, extent, and composition were recorded.

Where materials of a similar nature exist, to those previously sampled, and a reasoned argument can be made that their composition is likely to be identical further physical sampling was not undertaken.

Photographs were taken of all sample locations, unless otherwise stated.

The analysis of suspect ACMs was undertaken by a UKAS accredited laboratory using the analytical method detailed in *HSG248, Appendix 2 -Asbestos: The analysts' guide for sampling, analysis and clearance procedures*.

Document Name	Author	Issued by	Revision Number	Issue Date	Page No
2019	Kacey Lillis	Armour AS	0	28/10/2019	14

Section 8: Survey Caveat

This report is based upon a management report inspection of an unfamiliar site. During the course of the survey all reasonable efforts were made to identify the physical presence of materials containing asbestos within the building.

A Management Survey is a non-intrusive survey, meaning that access within the fabric of the building is limited. The survey does not include access to the following areas (unless agreed beforehand with the Client and provisions are put in place):

- Within wall or ceiling construction;
- Under fixed flooring;
- Within non-openable boxings;
- Within live electrics, boilers or machinery;
- Where access/visibility is limited in an area due to stored items, furniture or services;
- Areas where there is no safe access to inspect such as floor ducts, lift shafts and loft spaces with no crawlboards;
- High level areas that are too high to safely inspect.
- Within pipework insulation throughout building as this would affect the integrity of services.

Any intrusive works carried out within the building must first be subject to a Refurbishment Asbestos Survey.

This report will be restricted to the areas that fall within the scope of works for project and will not take into account any area's that do not fall within the scope. Any asbestos that is identified within this report will need to be added to the buildings existing information and should not form the basis for a management survey. This survey will not include priority assessments nor will it include a register.

This survey considered the construction of the building, associated fixtures & fittings and associated structures and in no way should it be considered as a ground investigation report.

Services should be disconnected prior to commencement of a Management survey; however, where plant and/or electrical installations are live or appear to be live then these will not be accessed.

This survey report is not a bill of quantities.

Document Name	Author	Issued by	Revision Number	Issue Date	Page No
2019	Kacey Lillis	Armour AS	0	28/10/2019	15

Section 9: Survey Notes

This report has been written with reference to the various Guidance Notes etc, issued, and current at the date of this report and describes circumstances at the site on the date the investigation took place.

Where similar items exist in the building, only one or two samples have been taken to ascertain the material content. It was assumed that similar products were of the same material.

Any person undertaking work within the buildings should be told of the presence of asbestos. This briefing also applies to any other person associated with the site, including staff, sub-contractors and others.

The drawings in the report are not to scale and are illustrative only to indicate approximate locations. The descriptions used are for location identification purposes.

All the recommendations described in this report are based upon assumptions made after consideration of the type of material, condition of the material, its location, analysis result and type of use the area is thought to be subjected to. However, statutory authorities or others could require amendments based on local knowledge, change in legislation, change in use or indeed other conditions or criteria.

Samples taken from floor tiles (or similar material) may include a bitumen adhesive as part of the sample. It is known that some proprietary brands of bitumen have an asbestos content and this will be included as an integral part of the bulk sample unless otherwise stated.

Document Name	Author	Issued by	Revision Number	Issue Date	Page No
2019	Kacey Lillis	Armour AS	0	28/10/2019	16

Section 10: Material Assessment Algorithm

Variable	Score	Examples
Installation / Product type	1	Vinyl, 'Bakelite', Cement
	2	Asbestos insulating board, paper, rope
	3	Pipe insulation, spray coating, friable debris
Condition / damage	0	Good
	1	Slight / minor damage
	2	Moderate damage – breakage to surface treatment
	3	Major damage – smashed or exposed material
Surface treatment	0	Non-friable e.g. vinyl
	1	Enclosed insulation, encapsulated AIB
	2	Unsealed AIB, encapsulated insulation
	3	Unsealed insulation or spray coating
Asbestos type	1	Chrysotile
	2	Amosite & other amphiboles
	3	Crocidolite

The scores from each of the four sections are added together to produce a risk score:

Risk score	Risk assessment
10 or more	High risk
7 – 9	Medium risk
5 – 6	Low risk
4 & below	Negligible risk

Document Name	Author	Issued by	Revision Number	Issue Date	Page No
2019	Kacey Lillis	Armour AS	0	28/10/2019	17



Section 11: Certificates of Bulk Analysis



Our Ref: J175775 FI: 2
Your Ref: 2481
Date: 20/09/2019

ENVIROCHEM
Analytical Laboratories Ltd.
12 The Gardens
Broadcut, Fareham
Hampshire
PO16 8SS



Tel: (01329) 287777
Fax: (01329) 287755
www.envirochem.co.uk
office@envirochem.co.uk

Asbestos Fibre Identification Report

Client: Armour Analytical Services Ltd
Admirals Yard, Station Road, Patchway, Bristol, BS34 6LR
Site Address: Looe Platoon, Sunrising Estate, Looe, PL13 1NA
Sampled By: Armour Analytical Services Ltd
Date sampled/received: 19th September 2019
Date analysed: 20th September 2019
Analyst/s: Ewelina Kowalczyk Pariyar
Analysis Location: 12 The Gardens, Broadcut, Fareham, Hampshire, PO16 8SS

ANALYTICAL PROCEDURE

Fibre identification was carried out in accordance with the documented 'in-house' methods based on the HSE Guidance Note HSG 248. These employed stereo microscopy, polarized microscopy and dispersion staining techniques.

RESULTS

Sample No.	Sample Ref.	Location	Asbestos Detected	Asbestos Type
DK/1	BS575810	Kitchen & Lobby – Floor Tiles	No	
DK/2	BS575811	Drill Hall – Insulation Board Panels on Ceiling	No	

NOTES:

1. Sample(s) were examined for the presence of 6 types of asbestos fibres: crocidolite (blue), amosite (brown), chrysotile (white), anthophyllite, actinolite and tremolite.
2. Samples collected by the client are evaluated using information provided by the client. For samples collected by the client the date of receipt is deemed to be the same as the date sampled.
3. Envirochem is a UKAS accredited laboratory for sampling and identification of asbestos containing materials.
4. Comments, observations and opinions are outside the scope of UKAS accreditation.
5. The analytical method in the HSG248 does not quantify the amount of asbestos present, therefore UKAS accreditation does not permit quantification.
6. If, during fibre identification, only 1 or 2 fibres are seen and identified as asbestos, then the term 'trace asbestos identified' is used.

SIGNATURE:

Authorised signatory

PRINT NAME: Frances Scott

Reg. No. 2378228 England. Registered Office: Envirochem, 12 The Gardens, Broadcut, Fareham, Hampshire, PO16 8SS.

Page 1 of 1

Document Name	Author	Issued by	Revision Number	Issue Date	Page No
2019	Kacey Lillis	Armour AS	0	28/10/2019	18

Section 12: Site Plan

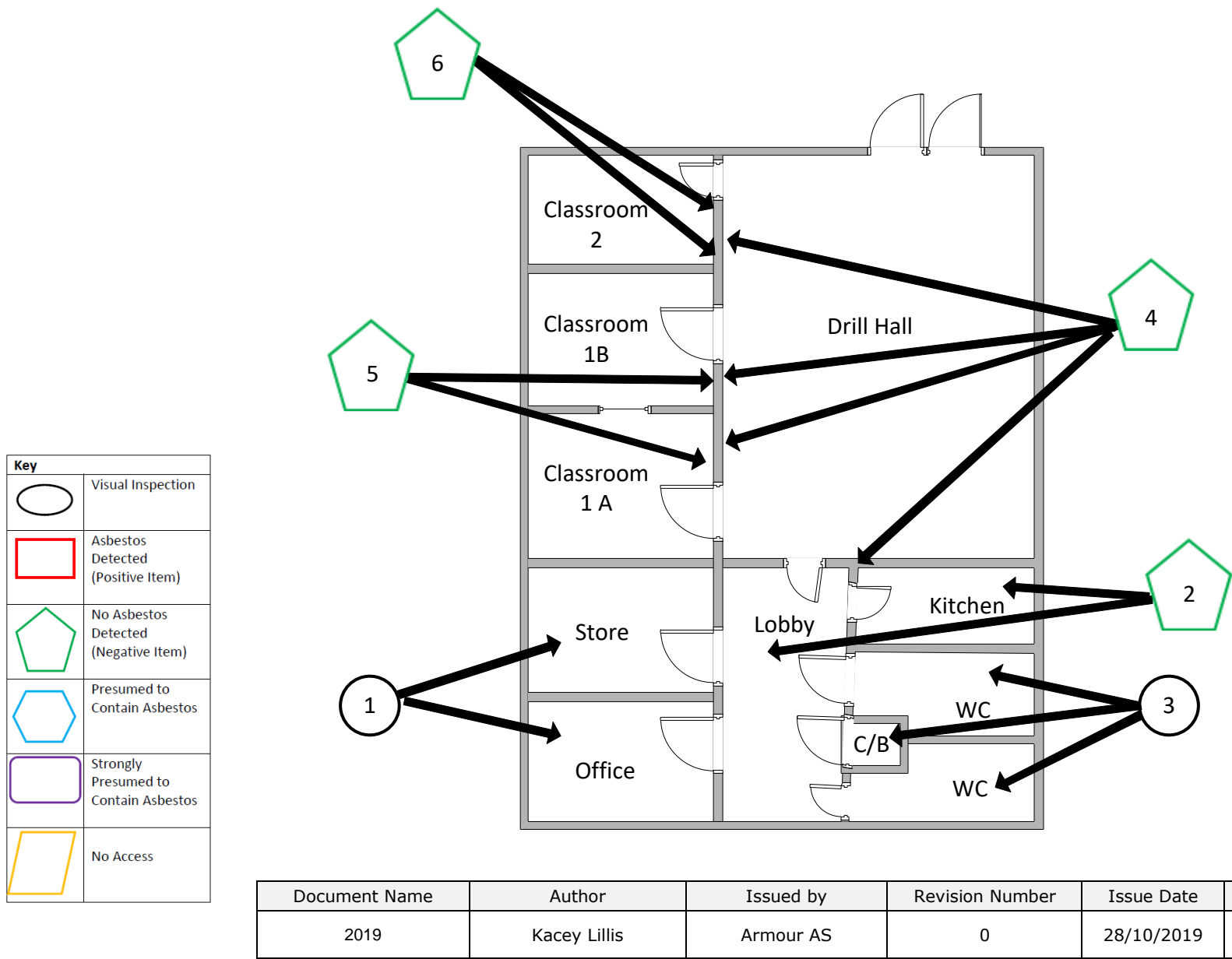



ARMOUR
ANALYTICAL SERVICES

I the surveyor can confirm that this report is accurate to my findings onsite and this survey has been Content checked by myself.

Checked by: David Kelly

Date: 27/10/2019

I the Admin Manager can confirm that this report is accurate to the paperwork received and this survey has been quality checked by myself.

Checked by: Emma Humphreys

Date: 24.10.2019

Report Compiled By

Armour Analytical Services Ltd, Admirals Yard, Station Road, Bristol, BS34 6LR

Document Name	Author	Issued by	Revision Number	Issue Date	Page No
2019	Kacey Lillis	Armour AS	0	28/10/2019	20