

**Project Number A-00419 (3700)**

**Re-Inspection  
Asbestos Survey Report**

**Bournemouth Platoon  
Portman Road  
Bournemouth  
BH7 6EU**



Working in Partnership with Shield Services Group

Document Name	Author	Issued by	Revision Number	Issue Date	Page No
2020	David Kelly	Armour AS	0	21/12/2020	1

## **Contents**

<b>Section</b>	
<b>1</b>	<b>Contact Details</b>
<b>2</b>	<b>Executive Summary</b>
<b>3</b>	<b>Site Description &amp; Survey Information</b>
<b>4</b>	<b>Positive, Presumed or No Access Items</b>
<b>5</b>	<b>Negative Photos Sheets</b>
<b>6</b>	<b>Survey Objectives</b>
<b>7</b>	<b>Survey Notes</b>
<b>8</b>	<b>Material Assessment Algorithm</b>
<b>9</b>	<b>Certificates of Bulk Analysis</b>
<b>10</b>	<b>Site Plan</b>

Document Name	Author	Issued by	Revision Number	Issue Date	Page No
2020	David Kelly	Armour AS	0	21/12/2020	2

## **Section 1: Contact Details**

<b>Client Details:</b>		<b>Instructing Party:</b>	
Wessex RFCA Mount House Mount Street Taunton TA1 3QE		Shield Caxton Business Park Warmley BS30 8XJ	
<b>Contact Name:</b>	Kelvin Walker	<b>Contact Name:</b>	Chloe Smith
<b>Tel:</b> 01823 250116	<b>Fax:</b> N/A	<b>Tel:</b> 01173012650	<b>Fax:</b> N/A

<b>Site Address:</b>		<b>Report Author:</b>	
Bornemouth Platoon Portman Road Bournemouth BH7 6EU		Armour Analytical Services Admirals Yard Station Road Bristol BS34 6LR	
<b>Contact Name:</b>	Kelvin Walker	<b>Contact Name:</b>	Emma Humphreys
<b>Tel:</b> 01823 250116	<b>Fax:</b> N/A	<b>Mobile:</b> 07468535836	

<b>Lead Surveyor's Name:</b>	<b>Lead Surveyor's Authorising Signature:</b>
David Kelly	

Document Name	Author	Issued by	Revision Number	Issue Date	Page No
2020	David Kelly	Armour AS	0	21/12/2020	3

## **Section 2: Executive Summary**

No samples were taken during this survey.

In addition to the above sampled items, the following items have been either been "Strongly Presumed" To Contain Asbestos or "Presumed" to Contain Asbestos as they were either visually identified in being so, labelled after previously being sampled on prior surveys or not accessible at the time of the survey:

Status	Sample Type	Location
Presumed	Heater - No Access Gained	Ground Floor Link Training Room 003
Presumed	Adhesive Under Parquet Flooring- Bituminous Product	Ground Floor Drill Hall Stores 004
Presumed	Glowworm Boiler - No Access Gained	Ground Floor Mezzanine Above Link Room/Store 005
Presumed	Glowworm Boiler - No Access Gained	Ground Floor Cadet Mess 006
Previously Sampled	Ceiling - Textured Coating	Ground Floor Store 007
Previously Sampled	Floor Tiles And Adhesive- Vinyl Products	Ground Floor Circulation And Cupboard 008
Previously Sampled	Ceiling - Textured Coating	Ground Floor Officers Mess Room 010
Previously Sampled	Panel on Door - Insulating Board	Ground Floor Circulation and Store 014
Presumed	Electrical Panel - No Access Gained	Ground Floor Drill Hall Store 015
Previously Sampled	Ceiling - Textured Coating	First Floor Stairwell and Landing 012
Previously Sampled	Ceilings - Textured Coating	First Floor Offices X 2 013
Previously Sampled	Roof Tiles - Cement Product	External Roof 001
Previously Sampled	Debris - Cement Product	External Floor 002

The presence of asbestos in these areas cannot be ascertained at this time. If any works are to be carried out in these areas in the future, then these works should be approached cautiously.

In accordance with current legislation, any suspect materials encountered in these areas are to be assumed to contain asbestos until proven otherwise. This will normally involve cessation of works in the affected area.

Document Name	Author	Issued by	Revision Number	Issue Date	Page No
2020	David Kelly	Armour AS	0	21/12/2020	4

## **Section 3: Site Description & Survey Information**

### **Brief description on the general building construction**

Brick construction with a pitched metal roof and roof tiles to house section.

### **Caveat for no access areas**

No access within live heaters, electrics, or boilers.

### **EXTERNAL MATERIALS**

Roof Type	Pitched/Flat
Roof Materials	Metal, Cement Tiles, Felt
Soffits	N/A
Fascia	Timber, Metal
Walls	Brick, Block, Timber
Verge Under cloaking	N/A
Guttering	Plastic
Downpipes	Metal, Plastic
Window/Door frames	Timber, Aluminum
Other Materials	Cement Debris to Side Of House

### **INTERNAL MATERIALS**

Loft Insulation	Fiberglass
Roof Underlining	Foam Boarding
Ceilings	Fiberboard, Plasterboard, Concrete, Lath and Plaster
Walls <i>Internal</i>	Brick, Lath & Plaster, Plasterboard
Floors	Carpet, Lino, Timber, Tiles
Doors/Frames	Timber, AIB To One Door
Pipework/Insulation	Copper, Armaflex, MMMF
Boxings	Plasterboard, Timber
Boiler Make	Glow-Worm
Flue Pipes	Metal
Storage Heaters	No Access Within Heaters
Electrical Boxes/Machinery	No Access Within Live Electrics
Ducting/Risers	N/A
Stairs	Timber
Lift Shafts	N/A
Other Materials	N/A

Document Name	Author	Issued by	Revision Number	Issue Date	Page No
2020	David Kelly	Armour AS	0	21/12/2020	5

## Section 4: Positive, Presumed or No Access Items

<b>Item No:</b>	<b>1</b>	<b>Sample No:</b>	<b>N/A</b>
<b>Location:</b>	External - Roof 001		



<b>Material Description:</b>	Roof Tiles - Cement Product	
<b>Identification:</b>	Previously Sampled - Asbestos Detected	
<b>Approx. quantity:</b>	30 m <sup>2</sup>	
<b>Accessibility</b>	Difficult	Assessment Score
<b>Product type:</b>	Cement	1
<b>Extent of Damage:</b>	Slight / minor damage	1
<b>Surface Treatment:</b>	Unsealed Cement	1
<b>Asbestos type:</b>	Chrysotile	1
<b>Material Assessment Score:</b>		4
<b>Priority Assessment Score:</b>		Negligible
<b>Action:</b>	Manage	
<b>Comments:</b>	Previously sampled ref: Armour 30/9/19 Sample DK/1	

Document Name	Author	Issued by	Revision Number	Issue Date	Page No
2020	David Kelly	Armour AS	0	21/12/2020	6

<b>Item No:</b>	<b>2</b>	<b>Sample No:</b>	<b>N/A</b>
<b>Location:</b>	External - Floor 002		



<b>Material Description:</b>	Debris - Cement Product	
<b>Identification:</b>	Previously Sampled - Asbestos Detected	
<b>Approx. quantity:</b>	1 m <sup>2</sup>	
<b>Accessibility</b>	Easy	<i>Assessment Score</i>
<b>Product type:</b>	Cement	1
<b>Extent of Damage:</b>	Major damage	3
<b>Surface Treatment:</b>	Unsealed Cement	1
<b>Asbestos type:</b>	Chrysotile	1
<b>Material Assessment Score:</b>		6
<b>Priority Assessment Score:</b>		Low
<b>Action:</b>	Remove	
<b>Comments:</b>	Previously sampled ref: Armour 30/9/19 Sample DK/2	

Document Name	Author	Issued by	Revision Number	Issue Date	Page No
2020	David Kelly	Armour AS	0	21/12/2020	7



<b>Item No:</b>	<b>3</b>	<b>Sample No:</b>	<b>N/A</b>
<b>Location:</b>	Ground Floor - Link Training Room 003		



<b>Material Description:</b>	Heater - No Access Gained	
<b>Identification:</b>	Presumed to Contain Asbestos	
<b>Approx. quantity:</b>	1 no	
<b>Accessibility</b>	Difficult	<i>Assessment Score</i>
<b>Product type:</b>	Asbestos insulating board	2
<b>Extent of Damage:</b>	Major damage	3
<b>Surface Treatment:</b>	Unsealed AIB	2
<b>Asbestos type:</b>	Amosite, Chrysotile	2
<b>Material Assessment Score:</b>		9
<b>Priority Assessment Score:</b>		Medium
<b>Action:</b>	Manage	
<b>Comments:</b>	No access within live heater	

Document Name	Author	Issued by	Revision Number	Issue Date	Page No
2020	David Kelly	Armour AS	0	21/12/2020	8



<b>Item No:</b>	<b>4</b>	<b>Sample No:</b>	<b>N/A</b>
<b>Location:</b>	Ground Floor - Drill Hall Stores 004		



<b>Material Description:</b>	Adhesive under Parquet Flooring - Bituminous Product	
<b>Identification:</b>	Presumed to Contain Asbestos	
<b>Approx. quantity:</b>	4 m <sup>2</sup>	
<b>Accessibility</b>	Difficult	<i>Assessment Score</i>
<b>Product type:</b>	Bitumen	1
<b>Extent of Damage:</b>	Minor damage	1
<b>Surface Treatment:</b>	Non-Friable	0
<b>Asbestos type:</b>	Chrysotile	1
<b>Material Assessment Score:</b>		3
<b>Priority Assessment Score:</b>		Negligible
<b>Action:</b>	Manage	
<b>Comments:</b>	No access under flooring without causing irreparable damage	

Document Name	Author	Issued by	Revision Number	Issue Date	Page No
2020	David Kelly	Armour AS	0	21/12/2020	9

<b>Item No:</b>	<b>5</b>	<b>Sample No:</b>	<b>N/A</b>
<b>Location:</b>	Ground Floor - Mezzanine Above Link Room/Store 005		



<b>Material Description:</b>	Glowworm Boiler - No Access Gained	
<b>Identification:</b>	Presumed to Contain Asbestos	
<b>Approx. quantity:</b>	1 no	
<b>Accessibility</b>	Difficult	<i>Assessment Score</i>
<b>Product type:</b>	Asbestos insulating board	2
<b>Extent of Damage:</b>	Major damage	3
<b>Surface Treatment:</b>	Unsealed AIB	2
<b>Asbestos type:</b>	Amosite, Chrysotile	2
<b>Material Assessment Score:</b>		9
<b>Priority Assessment Score:</b>		Medium
<b>Action:</b>	Manage	
<b>Comments:</b>	No access within live boiler	

Document Name	Author	Issued by	Revision Number	Issue Date	Page No
2020	David Kelly	Armour AS	0	21/12/2020	10

<b>Item No:</b>	<b>6</b>	<b>Sample No:</b>	<b>N/A</b>
<b>Location:</b>	Ground Floor - Cadet Mess 006		



<b>Material Description:</b>	Glowworm Boiler - No Access Gained	
<b>Identification:</b>	Presumed to Contain Asbestos	
<b>Approx. quantity:</b>	1 no	
<b>Accessibility</b>	Difficult	<i>Assessment Score</i>
<b>Product type:</b>	Asbestos insulating board	2
<b>Extent of Damage:</b>	Major damage	3
<b>Surface Treatment:</b>	Unsealed AIB	2
<b>Asbestos type:</b>	Amosite, Chrysotile	2
<b>Material Assessment Score:</b>		9
<b>Priority Assessment Score:</b>		Medium
<b>Action:</b>	Manage	
<b>Comments:</b>	No access within live boiler	

Document Name	Author	Issued by	Revision Number	Issue Date	Page No
2020	David Kelly	Armour AS	0	21/12/2020	11

<b>Item No:</b>	<b>7</b>	<b>Sample No:</b>	<b>N/A</b>
<b>Location:</b>	Ground Floor - Store 007		



<b>Material Description:</b>	Ceiling - Textured Coating	
<b>Identification:</b>	Previously Sampled - Asbestos Detected	
<b>Approx. quantity:</b>	15 m <sup>2</sup>	
<b>Accessibility</b>	Difficult	<i>Assessment Score</i>
<b>Product type:</b>	Textured Coating	1
<b>Extent of Damage:</b>	Slight / minor damage	1
<b>Surface Treatment:</b>	Non-friable	0
<b>Asbestos type:</b>	Chrysotile	1
<b>Material Assessment Score:</b>		3
<b>Priority Assessment Score:</b>		Negligible
<b>Action:</b>	Manage	
<b>Comments:</b>	Previously sampled ref: Armour 30/9/19 Sample DK/4	

Document Name	Author	Issued by	Revision Number	Issue Date	Page No
2020	David Kelly	Armour AS	0	21/12/2020	12

<b>Item No:</b>	<b>8</b>	<b>Sample No:</b>	<b>N/A</b>
<b>Location:</b>	Ground Floor - Circulation and Cupboard 008		



<b>Material Description:</b>	Floor Tiles and Adhesive - Vinyl Products	
<b>Identification:</b>	Previously Sampled - Asbestos Detected	
<b>Approx. quantity:</b>	5 m <sup>2</sup>	
<b>Accessibility</b>	Difficult	<i>Assessment Score</i>
<b>Product type:</b>	Vinyl	1
<b>Extent of Damage:</b>	Slight / minor damage	1
<b>Surface Treatment:</b>	Non-friable	0
<b>Asbestos type:</b>	Chrysotile	1
<b>Material Assessment Score:</b>		3
<b>Priority Assessment Score:</b>		Negligible
<b>Action:</b>	Manage	
<b>Comments:</b>	Under carpet. Previously sampled ref: Armour 30/9/19 Sample DK/5	

Document Name	Author	Issued by	Revision Number	Issue Date	Page No
2020	David Kelly	Armour AS	0	21/12/2020	13

<b>Item No:</b>	<b>10</b>	<b>Sample No:</b>	<b>N/A</b>
<b>Location:</b>	Ground Floor - Officers Mess Room 010		



<b>Material Description:</b>	Ceiling - Textured Coating	
<b>Identification:</b>	Previously Sampled - Asbestos Detected	
<b>Approx. quantity:</b>	20 m <sup>2</sup>	
<b>Accessibility</b>	Difficult	<i>Assessment Score</i>
<b>Product type:</b>	Textured Coating	1
<b>Extent of Damage:</b>	Slight / minor damage	1
<b>Surface Treatment:</b>	Non-friable	0
<b>Asbestos type:</b>	Chrysotile	1
<b>Material Assessment Score:</b>		3
<b>Priority Assessment Score:</b>		Negligible
<b>Action:</b>	Manage	
<b>Comments:</b>	Previously sampled ref: Armour 30/9/19 Sample DK/8	

Document Name	Author	Issued by	Revision Number	Issue Date	Page No
2020	David Kelly	Armour AS	0	21/12/2020	14



<b>Item No:</b>	<b>12</b>	<b>Sample No:</b>	<b>N/A</b>
<b>Location:</b>	First Floor - Stairwell and Landing 012		



<b>Material Description:</b>	Ceiling - Textured Coating	
<b>Identification:</b>	Previously Sampled - Asbestos Detected	
<b>Approx. quantity:</b>	8 m <sup>2</sup>	
<b>Accessibility</b>	Difficult	<i>Assessment Score</i>
<b>Product type:</b>	Textured Coating	1
<b>Extent of Damage:</b>	Slight / minor damage	1
<b>Surface Treatment:</b>	Non-friable	0
<b>Asbestos type:</b>	Chrysotile	1
<b>Material Assessment Score:</b>		3
<b>Priority Assessment Score:</b>		Negligible
<b>Action:</b>	Manage	
<b>Comments:</b>	Previously sampled ref: Armour 30/9/19 Sample DK/9	

Document Name	Author	Issued by	Revision Number	Issue Date	Page No
2020	David Kelly	Armour AS	0	21/12/2020	15



<b>Item No:</b>	<b>13</b>	<b>Sample No:</b>	<b>N/A</b>
<b>Location:</b>	First Floor - Offices x 2 013		



<b>Material Description:</b>	Ceilings - Textured Coating	
<b>Identification:</b>	Previously Sampled - Asbestos Detected	
<b>Approx. quantity:</b>	15 m <sup>2</sup>	
<b>Accessibility</b>	Easy	<i>Assessment Score</i>
<b>Product type:</b>	Textured Coating	1
<b>Extent of Damage:</b>	Moderate damage	2
<b>Surface Treatment:</b>	Non-friable	0
<b>Asbestos type:</b>	Chrysotile	1
<b>Material Assessment Score:</b>		4
<b>Priority Assessment Score:</b>		Negligible
<b>Action:</b>	Encapsulate	
<b>Comments:</b>	Previously sampled ref: Armour 30/9/19 Sample DK/9	

Document Name	Author	Issued by	Revision Number	Issue Date	Page No
2020	David Kelly	Armour AS	0	21/12/2020	16

<b>Item No:</b>	<b>14</b>	<b>Sample No:</b>	<b>N/A</b>
<b>Location:</b>	Ground Floor - Circulation and Store 014		



<b>Material Description:</b>	Panel on Door - Insulating Board	
<b>Identification:</b>	Previously Sampled - Asbestos Detected	
<b>Approx. quantity:</b>	2 m <sup>2</sup>	
<b>Accessibility</b>	Easy	Assessment Score
<b>Product type:</b>	Asbestos insulating board	2
<b>Extent of Damage:</b>	Moderate damage	2
<b>Surface Treatment:</b>	Unsealed AIB	2
<b>Asbestos type:</b>	Amosite	2
<b>Material Assessment Score:</b>		8
<b>Priority Assessment Score:</b>		Medium
<b>Action:</b>	Encapsulate	
<b>Comments:</b>	Previously sampled ref: Armour 30/9/19 Sample DK/10. Encapsulate and label or remove if in constant use	

Document Name	Author	Issued by	Revision Number	Issue Date	Page No
2020	David Kelly	Armour AS	0	21/12/2020	17

<b>Item No:</b>	<b>15</b>	<b>Sample No:</b>	<b>N/A</b>
<b>Location:</b>	Ground Floor - Drill Hall Store 015		



<b>Material Description:</b>	Electrical Panel - No Access Gained	
<b>Identification:</b>	Presumed to Contain Asbestos	
<b>Approx. quantity:</b>	1 no	
<b>Accessibility</b>	Difficult	<i>Assessment Score</i>
<b>Product type:</b>	Flashguards	2
<b>Extent of Damage:</b>	Minor damage	1
<b>Surface Treatment:</b>	Woven	1
<b>Asbestos type:</b>	Chrysotile	1
<b>Material Assessment Score:</b>		5
<b>Priority Assessment Score:</b>		Low
<b>Action:</b>	Manage	
<b>Comments:</b>	No access within live electrics	

Document Name	Author	Issued by	Revision Number	Issue Date	Page No
2020	David Kelly	Armour AS	0	21/12/2020	18

## Section 5: Negative Items

<b>Item No:</b>	9	<b>Sample No:</b>	N/A
<b>Location:</b>	Ground Floor - WC 009		



<b>Material Description:</b>	No Suspect Materials Found	
<b>Identification:</b>	N/A	
<b>Approx. quantity:</b>	N/A	
<b>Accessibility</b>	N/A	<i>Assessment Score</i>
<b>Product type:</b>	N/A	N/A
<b>Extent of Damage:</b>	N/A	N/A
<b>Surface Treatment:</b>	N/A	N/A
<b>Asbestos type:</b>	N/A	N/A
<b>Material Assessment Score:</b>		
<b>Priority Assessment Score:</b>		
<b>Action:</b>	N/A	
<b>Comments:</b>	Asbestos ceiling was removed and replaced following a roof leak	

Document Name	Author	Issued by	Revision Number	Issue Date	Page No
2020	David Kelly	Armour AS	0	21/12/2020	19

<b>Item No:</b>	<b>11</b>	<b>Sample No:</b>	<b>N/A</b>
<b>Location:</b>	Ground Floor - WC 011		



<b>Material Description:</b>	No Suspect Materials Found	
<b>Identification:</b>	N/A	
<b>Approx. quantity:</b>	N/A	
<b>Accessibility</b>	N/A	<i>Assessment Score</i>
<b>Product type:</b>	N/A	N/A
<b>Extent of Damage:</b>	N/A	N/A
<b>Surface Treatment:</b>	N/A	N/A
<b>Asbestos type:</b>	N/A	N/A
<b>Material Assessment Score:</b>		
<b>Priority Assessment Score:</b>		
<b>Action:</b>	N/A	
<b>Comments:</b>	Asbestos ceiling was removed and replaced following a roof leak	

Document Name	Author	Issued by	Revision Number	Issue Date	Page No
2020	David Kelly	Armour AS	0	21/12/2020	20



## **Section 6: Survey Objectives**

Instructions were received from Kelvin Walker of Wessex RFCA to carry out a Re-Inspection asbestos survey at Bornemouth Platoon, Portman Road, Bournemouth, BH7 6EU in accordance with HSG264 and Armour Analytical's quality procedures.

The survey was carried out on 17 December 2020 by David Kelly with the objective of facilitating a Re-Inspection report.

Document Name	Author	Issued by	Revision Number	Issue Date	Page No
2020	David Kelly	Armour AS	0	21/12/2020	21

## **Section 7: Survey Notes**

This report has been written with reference to the various Guidance Notes etc, issued, and current at the date of this report and describes circumstances at the site on the date the investigation took place.

Where similar items exist in the building, only one or two samples may have been taken to ascertain the material content. It was assumed that similar products were of the same material.

Any person undertaking work within the buildings should be told of the presence of asbestos. This briefing also applies to any other person associated with the site, including staff, sub-contractors and others.

The drawings in the report are not to scale and are illustrative only to indicate approximate locations. The descriptions used are for location identification purposes.

All the recommendations described in this report are based upon assumptions made after consideration of the type of material, condition of the material, its location, analysis result and type of use the area is thought to be subjected to. However, statutory authorities or others could require amendments based on local knowledge, change in legislation, change in use or indeed other conditions or criteria.

Samples taken from floor tiles (or similar material) may include a bitumen adhesive as part of the sample. It is known that some proprietary brands of bitumen have an asbestos content and this will be included as an integral part of the bulk sample unless otherwise stated.

Document Name	Author	Issued by	Revision Number	Issue Date	Page No
2020	David Kelly	Armour AS	0	21/12/2020	22



## **Section 8: Material Assessment Algorithm**

Variable	Score	Examples
Installation / Product type	1	Vinyl, 'Bakelite', Cement
	2	Asbestos Insulating Board, Paper, Rope
	3	Pipe Insulation, Spray Coating, Friable Debris
Condition / damage	0	Good
	1	Slight / Minor Damage
	2	Moderate Damage – Breakage To Surface Treatment
	3	Major Damage – Smashed Or Exposed Material
Surface treatment	0	Non-Friable E.G. Vinyl
	1	Enclosed Insulation, Rope Seal, Encapsulated AIB
	2	Unsealed AIB, Encapsulated Insulation
	3	Unsealed Insulation, Spray Coating
Asbestos type	1	Chrysotile
	2	Amosite & Other Amphiboles
	3	Crocidolite

The scores from each of the four sections are added together to produce a risk score:

Risk score	Risk assessment
<b>10 or more</b>	High risk
<b>7 – 9</b>	Medium risk
<b>5 – 6</b>	Low risk
<b>4 &amp; below</b>	Negligible risk





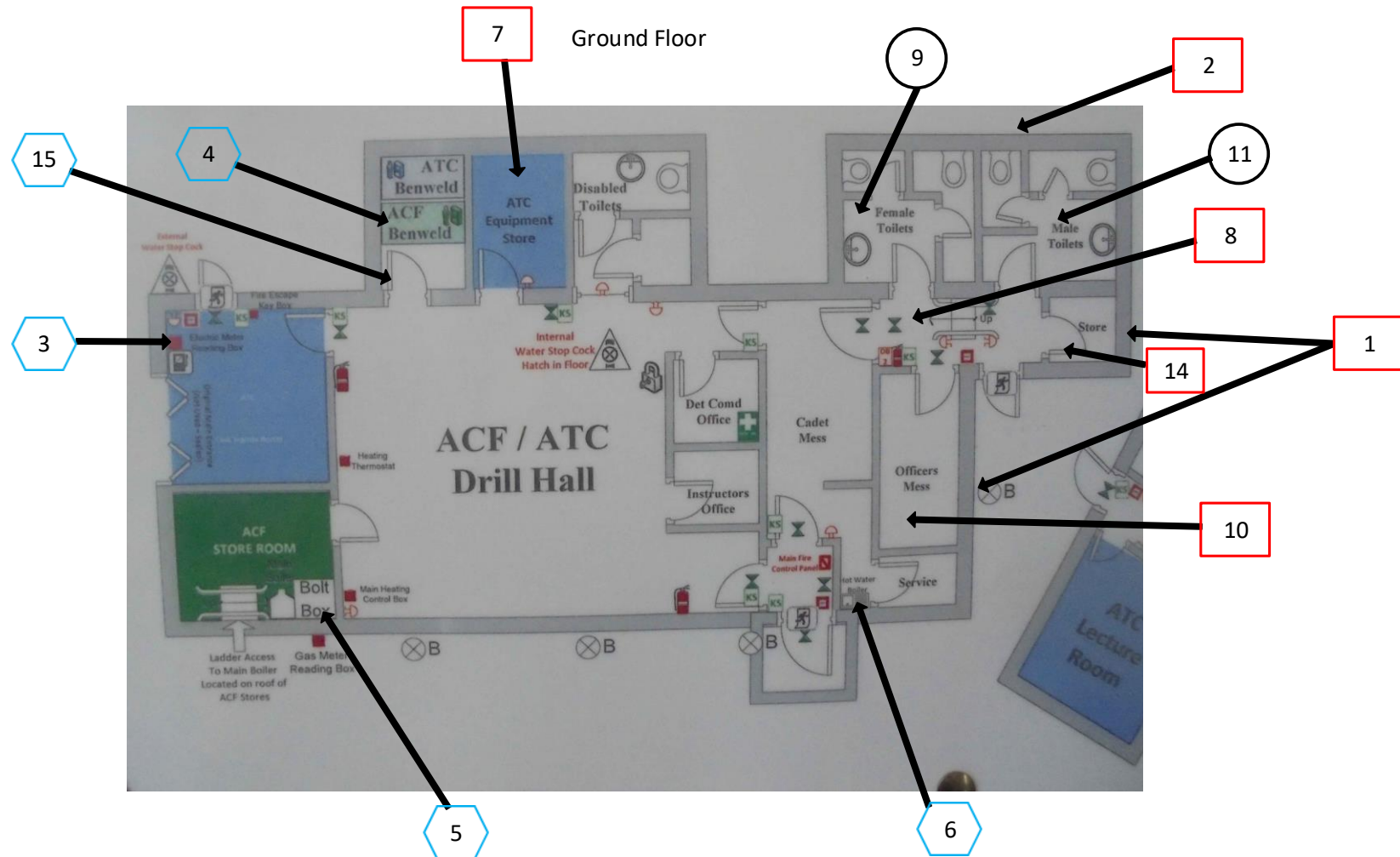

## **Section 9: Certificates of Bulk Analysis**

No samples were taken during this survey.

Document Name	Author	Issued by	Revision Number	Issue Date	Page No
2020	David Kelly	Armour AS	0	21/12/2020	24

## Section 10: Site Plan







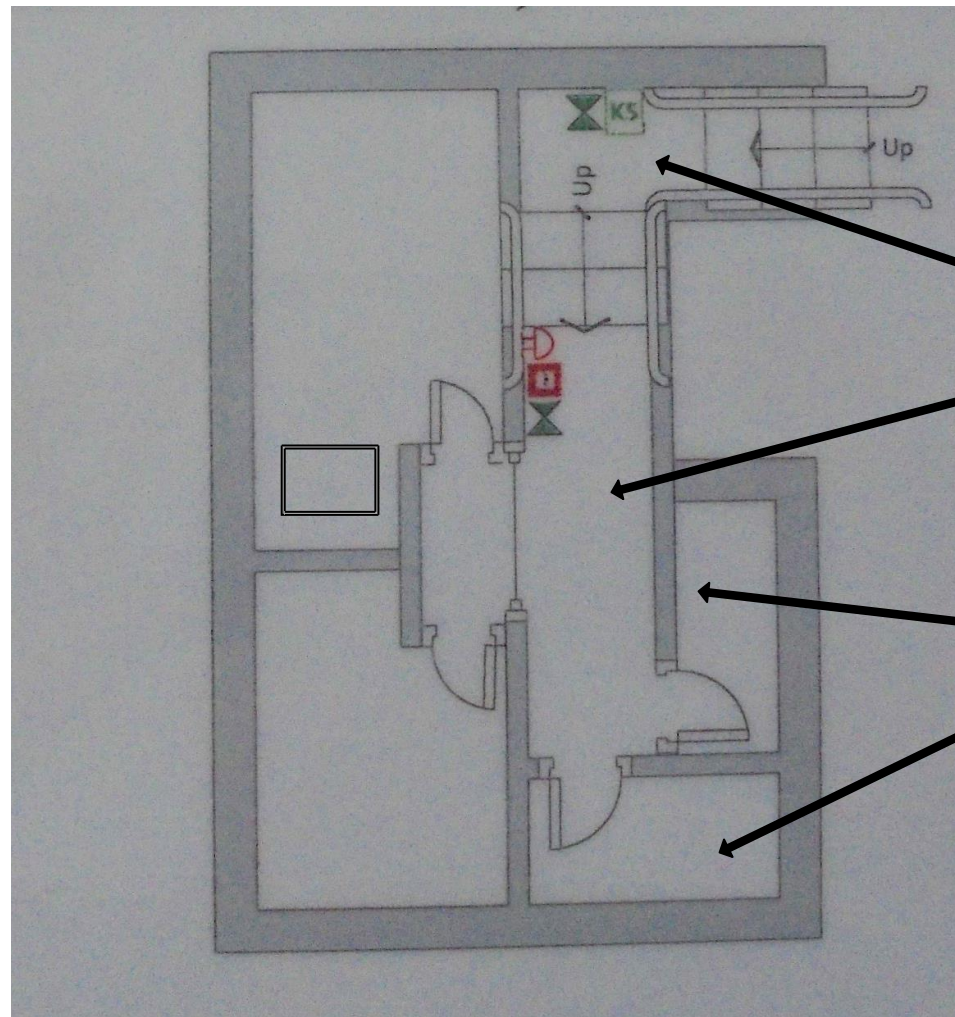

Key	
	Visual Inspection
	Asbestos Detected (Positive Item)
	No Asbestos Detected (Negative Item)
	Presumed to Contain Asbestos
	Strongly Presumed to Contain Asbestos
	No Access

Document Name	Author	Issued by	Revision Number	Issue Date	Page No
2020	David Kelly	Armour AS	0	21/12/2020	25

# First Floor



Key	
	Visual Inspection
	Asbestos Detected (Positive Item)
	No Asbestos Detected (Negative Item)
	Presumed to Contain Asbestos
	Strongly Presumed to Contain Asbestos
	No Access

Document Name	Author	Issued by	Revision Number	Issue Date	Page No
2020	David Kelly	Armour AS	0	21/12/2020	26



**I the surveyor can confirm that this report is accurate to my findings onsite and this survey has been Content checked by myself.**

**Checked by: David Kelly**

**Date: 20/12/2020**

**I the Admin Manager can confirm that this report is accurate to the paperwork received and this survey has been quality checked by myself.**

**Checked by: Emma Humphreys**

**Date: 18.12.2020**

**Report Compiled By**

**Armour Analytical Services Ltd, Admirals Yard, Station Road, Bristol, BS34 6LR**

Document Name	Author	Issued by	Revision Number	Issue Date	Page No
2020	David Kelly	Armour AS	0	21/12/2020	27