

Project Number A-00366 (3700)

**Re-Inspection
Asbestos Survey Report**

**Royal Wessex Yeomanry C
Gloucestershire
GL7 1TT**



Working in Partnership with Shield Services Group

Document Name	Author	Issued by	Revision Number	Issue Date	Page No
2020	David Kelly	Armour AS	0	02/12/2020	1

Contents

Section	
1	Contact Details
2	Executive Summary
3	Site Description and Survey Information
4	Positive, Presumed or No Access Items
5	Negative Photos Sheets
6	Survey Objectives
7	Survey Notes
8	Material Assessment Algorithm
9	Certificates of Bulk Analysis
10	Site Plan

Document Name	Author	Issued by	Revision Number	Issue Date	Page No
2020	David Kelly	Armour AS	0	02/12/2020	2

Section 1: Contact Details

Client Details:		Instructing Party:	
Wessex RFCA Mount House Mount Street Taunton TA1 3QE		Shield Caxton Business Park Warmley BS30 8XJ	
Contact Name:	Kelvin Walker	Contact Name:	Chloe Smith
Tel: 01823 250116	Fax: N/A	Tel: 01173012650	Fax: N/A

Site Address:		Report Author:	
Royal Wessex Yeomanry C Gloucestershire GL7 1TT		Armour Analytical Services Admirals Yard Station Road Bristol BS34 6LR	
Contact Name:	Capt Wayne Price	Contact Name:	Emma Humphreys
Tel: 01285868360	Fax: N/A	Mobile: 07468535836	

Lead Surveyor's Name:	Lead Surveyor's Authorising Signature:
David Kelly	

Document Name	Author	Issued by	Revision Number	Issue Date	Page No
2020	David Kelly	Armour AS	0	02/12/2020	3



Section 2: Executive Summary

No samples were taken during this survey.

Document Name	Author	Issued by	Revision Number	Issue Date	Page No
2020	David Kelly	Armour AS	0	02/12/2020	4



In addition to the above sampled items, the following items have been either been "Strongly Presumed" To Contain Asbestos or "Presumed" to Contain Asbestos as they were either visually identified in being so, labelled after previously being sampled on prior surveys or not accessible at the time of the survey:

Status	Sample Type	Location
Previously Sampled	Floor Tiles and Adhesive - Vinyl Products	Ground Floor Caretakers Store 005
Presumed	Safe - No Access Gained	Ground Floor AO Office 006
Presumed	Safe - No Access Gained	Ground Floor Office 007
Presumed	Wrap to Mains Cable - Bituminous Product	Ground Floor Firing Range Cupboard 008
Presumed	Wrap to Mains Cable - Bituminous Product	Ground Floor Silver Room 009
Presumed	Baxi Heater - No Access Gained	Ground Floor Store 011
Previously Sampled	Floor Tiles and Adhesive - Vinyl Products	Ground Floor Gym Block - Store 019
Presumed	Toilet Seat - Pvc / Reinforced Plastics	First Floor WC 002
Previously Sampled	Floor Tiles and Adhesive - Vinyl Products	First Floor Circulation and Server Room 003
Presumed	Safe - No Access Gained	First Floor Psi's Office 004
Previously Sampled	Red and Brown Floor Tiles and Adhesive - Vinyl Products	First Floor Cadet Area - Landing 020
Previously Sampled	Red and Brown Floor Tiles and Adhesive - Vinyl Products	First Floor Cadet Area - Cupboard and Wc 021
Previously Sampled	Red and Brown Floor Tiles and Adhesive - Vinyl Products	First Floor Cadet Area - Office 022
Previously Sampled	Floor Tiles and Adhesive - Vinyl Products	First Floor Cadet Area - Store and Cupboard 023
Previously Sampled	Floor Tiles and Adhesive - Vinyl Products	First Floor Cadet Area - Medical Officer Room 024
Presumed	Night Storage Heater - No Access Gained	First Floor Garage Block - Store and Mezzanine 031
Previously Sampled	Fireplace Panel - Cement Product	Second Floor Bedroom 1 001
Previously Sampled	Downpipes - Cement Product	External 012
Presumed	Profiled Roof - Cement Product	External to Drill Hall 014
Presumed	Roof Edging - Cement Product	External to Drill Hall 015
Previously Sampled	Profiled Roof - Cement Product	External to RGH Office 016

Document Name	Author	Issued by	Revision Number	Issue Date	Page No
2020	David Kelly	Armour AS	0	02/12/2020	5

Status	Sample Type	Location
Previously Sampled	Roof Edging - Cement Product	External to RGH Office 017
Previously Sampled	Roof Tiles - Cement Product	External to Training Room 018
Previously Sampled	Downpipes - Cement Product	External to Main Building 025
Previously Sampled	Guttering - Cement Product	External to Drill Hall 026
Presumed	Soffits - Insulating Board	External to Drill Hall 027
Presumed	Undercloaking To Gable Ends - Cement Product	External to Main Building 028
Previously Sampled	Roof Tiles - Cement Product	External to Main Building Porch 029
Presumed	Profiled Roof - Cement Product	External Garage Block - Garages 032
Presumed	Roof Edging - Cement Product	External Garage Block - Garages 033
Presumed	Roof Tiles - Cement Product	External Main Block - External 034

The presence of asbestos in these areas cannot be ascertained at this time. If any works are to be carried out in these areas in the future, then these works should be approached cautiously.

In accordance with current legislation, any suspect materials encountered in these areas are to be assumed to contain asbestos until proven otherwise. This will normally involve cessation of works in the affected area.

Document Name	Author	Issued by	Revision Number	Issue Date	Page No
2020	David Kelly	Armour AS	0	02/12/2020	6

Section 3: Site Description and Survey Information

Brief description on the general building construction

Stone construction with pitched cement tile, ceramic tile and profiled cement roofs.

Caveat for no access areas

No access within live heaters and safes.

EXTERNAL MATERIALS

Roof Type	Pitched
Roof Materials	Cement Tiles, Ceramic Tiles, Profiled Cement
Soffits	Presumed Insulation Board to Drill Hall
Fascia	Timber
Walls	Stone
Verge Under cloaking	Cement
Guttering	Cement, Plastic
Downpipes	Plastic, Cement
Window/Door frames	Timber, Aluminum
Other Materials	N/A

INTERNAL MATERIALS

Loft Insulation	Fiberglass
Roof Underlining	Non-Asbestos Felt
Ceilings	Plasterboard, Concrete, Suspended, Lath and Plaster, Supalux
Walls <i>Internal</i>	Brick, Plasterboard, Wood
Floors	Tiles, Lino, Screed, Timber, Carpet
Doors/Frames	Timber
Pipework/Insulation	Armaflex, Copper
Boxings	Plasterboard, Timber
Boiler Make	Vaillant
Flue Pipes	Metal
Storage Heaters	No Access Within Heaters
Electrical Boxes/Machinery	No Access
Ducting/Risers	Timber Risers
Stairs	Timber, Concrete
Lift Shafts	N/A
Other Materials	N/A

Document Name	Author	Issued by	Revision Number	Issue Date	Page No
2020	David Kelly	Armour AS	0	02/12/2020	7

Section 4: Positive, Presumed or No Access Items

Item No:	1	Sample No:	N/A
Location:	Second Floor - Bedroom 1 001		



Material Description:	Fireplace Panel - Cement Product	
Identification:	Previously Sampled - Asbestos Detected	
Approx. quantity:	1 m ²	
Accessibility	Easy	Assessment Score
Product type:	Cement	1
Extent of Damage:	Slight / Minor Damage	1
Surface Treatment:	Sealed Cement	0
Asbestos type:	Chrysotile	1
Material Assessment Score:		3
Priority Assessment Score:		Negligible
Action:	Manage	
Comments:	Previously sampled ref: Armour 2/10/19 - Sample DK/1	

Document Name	Author	Issued by	Revision Number	Issue Date	Page No
2020	David Kelly	Armour AS	0	02/12/2020	8

Item No:	2	Sample No:	N/A
Location:	First Floor - WC 002		



Material Description:	Toilet Seat - PVC / Reinforced Plastics	
Identification:	Presumed to Contain Asbestos	
Approx. quantity:	1 no	
Accessibility	Easy	<i>Assessment Score</i>
Product type:	Reinforced Plastics	1
Extent of Damage:	Minor Damage	1
Surface Treatment:	Non-Friable	0
Asbestos type:	Chrysotile	1
Material Assessment Score:		3
Priority Assessment Score:		Negligible
Action:	Manage	
Comments:	Not possible to sample as may damage integrity of seat	

Document Name	Author	Issued by	Revision Number	Issue Date	Page No
2020	David Kelly	Armour AS	0	02/12/2020	9

Item No:	3	Sample No:	N/A
Location:	First Floor - Circulation and Server Room 003		



Material Description:	Floor Tiles and Adhesive - Vinyl Products	
Identification:	Previously Sampled - Asbestos Detected	
Approx. quantity:	26 m ²	
Accessibility	Difficult	<i>Assessment Score</i>
Product type:	Vinyl	1
Extent of Damage:	Slight / Minor Damage	1
Surface Treatment:	Non-Friable	0
Asbestos type:	Chrysotile	1
Material Assessment Score:		3
Priority Assessment Score:		Negligible
Action:	Manage	
Comments:	Under carpet. Previously sampled ref: Armour 2/10/19 - Sample DK/4	

Document Name	Author	Issued by	Revision Number	Issue Date	Page No
2020	David Kelly	Armour AS	0	02/12/2020	10

Item No:	4	Sample No:	N/A
Location:	First Floor - PSI's Office 004		



Material Description:	Safe - No Access Gained	
Identification:	Presumed to Contain Asbestos	
Approx. quantity:	1 no	
Accessibility	Easy	<i>Assessment Score</i>
Product type:	Asbestos Insulating Board	2
Extent of Damage:	Major Damage	3
Surface Treatment:	Unsealed AIB	2
Asbestos type:	Amosite	2
Material Assessment Score:		9
Priority Assessment Score:		Medium
Action:	Manage	
Comments:	No access without damaging safe	

Document Name	Author	Issued by	Revision Number	Issue Date	Page No
2020	David Kelly	Armour AS	0	02/12/2020	11

Item No:	5	Sample No:	N/A
Location:	Ground Floor - Caretakers Store 005		



Material Description:	Floor Tiles and Adhesive - Vinyl Products	
Identification:	Previously Sampled - Asbestos Detected	
Approx. quantity:	8 m ²	
Accessibility	Easy	<i>Assessment Score</i>
Product type:	Vinyl	1
Extent of Damage:	Moderate Damage	2
Surface Treatment:	Non-Friable	0
Asbestos type:	Chrysotile	1
Material Assessment Score:		4
Priority Assessment Score:		Negligible
Action:	Manage	
Comments:	Previously sampled ref: Armour 2/10/19 - Sample DK/6	

Document Name	Author	Issued by	Revision Number	Issue Date	Page No
2020	David Kelly	Armour AS	0	02/12/2020	12

Item No:	6	Sample No:	N/A
Location:	Ground Floor - AO Office 006		



Material Description:	Safe - No Access Gained	
Identification:	Presumed to Contain Asbestos	
Approx. quantity:	1 no	
Accessibility	Difficult	<i>Assessment Score</i>
Product type:	Asbestos Insulating Board	2
Extent of Damage:	Major Damage	3
Surface Treatment:	Unsealed AIB	2
Asbestos type:	Amosite	2
Material Assessment Score:		9
Priority Assessment Score:		Medium
Action:	Manage	
Comments:	No access without damaging safe	

Document Name	Author	Issued by	Revision Number	Issue Date	Page No
2020	David Kelly	Armour AS	0	02/12/2020	13

Item No:	7	Sample No:	N/A
Location:	Ground Floor - Office 007		



Material Description:	Safe - No Access Gained	
Identification:	Presumed to Contain Asbestos	
Approx. quantity:	1 no	
Accessibility	Difficult	<i>Assessment Score</i>
Product type:	Asbestos Insulating Board	2
Extent of Damage:	Major Damage	3
Surface Treatment:	Unsealed AIB	2
Asbestos type:	Amosite	2
Material Assessment Score:		9
Priority Assessment Score:		Medium
Action:	Manage	
Comments:	No access without damaging safe	

Document Name	Author	Issued by	Revision Number	Issue Date	Page No
2020	David Kelly	Armour AS	0	02/12/2020	14

Item No:	8	Sample No:	N/A
Location:	Ground Floor - Firing Range Cupboard 008		



Material Description:	Wrap to Mains Cable - Bituminous Product	
Identification:	Presumed to Contain Asbestos	
Approx. quantity:	2 LM	
Accessibility	Easy	<i>Assessment Score</i>
Product type:	Bitumen	1
Extent of Damage:	Minor Damage	1
Surface Treatment:	Non-Friable	0
Asbestos type:	Chrysotile	1
Material Assessment Score:		3
Priority Assessment Score:		Negligible
Action:	Manage	
Comments:	Not possible to sample as live. 3 x Cables	

Document Name	Author	Issued by	Revision Number	Issue Date	Page No
2020	David Kelly	Armour AS	0	02/12/2020	15

Item No:	9	Sample No:	N/A
Location:	Ground Floor - Silver Room 009		

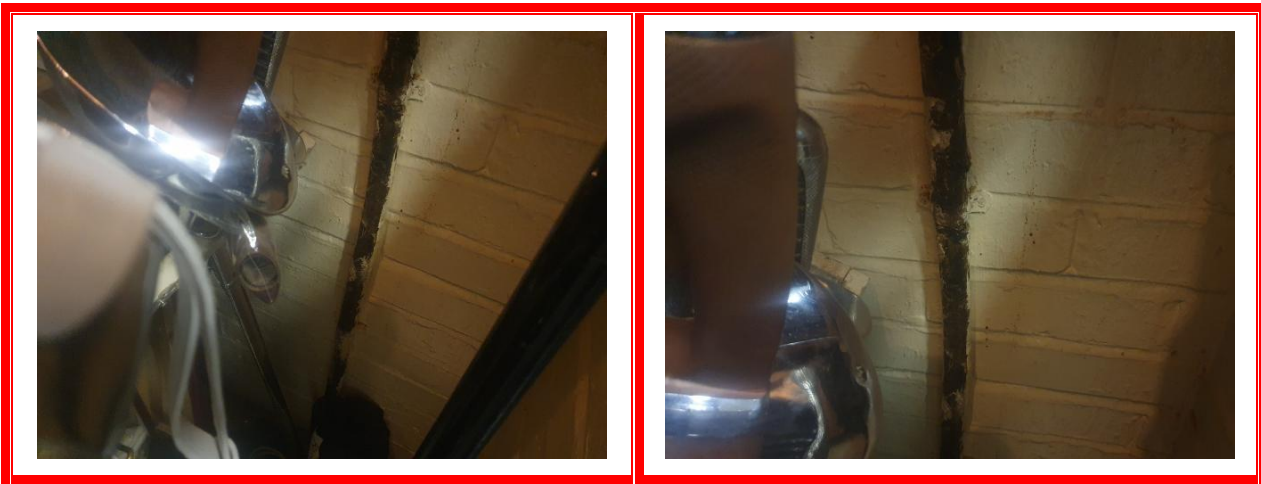

Material Description:	Wrap to Mains Cable - Bituminous Product	
Identification:	Presumed to Contain Asbestos	
Approx. quantity:	1 LM	
Accessibility	Easy	<i>Assessment Score</i>
Product type:	Bitumen	1
Extent of Damage:	Minor Damage	1
Surface Treatment:	Non-Friable	0
Asbestos type:	Chrysotile	1
Material Assessment Score:		3
Priority Assessment Score:		Negligible
Action:	Manage	
Comments:	Not possible to sample as live	

Document Name	Author	Issued by	Revision Number	Issue Date	Page No
2020	David Kelly	Armour AS	0	02/12/2020	16

Item No:	11	Sample No:	N/A
Location:	Ground Floor - Store 011		



Material Description:	Baxi Heater - No Access Gained	
Identification:	Presumed to Contain Asbestos	
Approx. quantity:	1 no	
Accessibility	Difficult	<i>Assessment Score</i>
Product type:	Asbestos Insulating Board	2
Extent of Damage:	Major Damage	3
Surface Treatment:	Unsealed AIB	2
Asbestos type:	Amosite	2
Material Assessment Score:		9
Priority Assessment Score:		Medium
Action:	Manage	
Comments:	Not possible to sample as live	

Document Name	Author	Issued by	Revision Number	Issue Date	Page No
2020	David Kelly	Armour AS	0	02/12/2020	17

Item No:	12	Sample No:	N/A
Location:	External 012		



Material Description:	Downpipes - Cement Product	
Identification:	Previously Sampled - Asbestos Detected	
Approx. quantity:	10 LM	
Accessibility	Easy	<i>Assessment Score</i>
Product type:	Cement	1
Extent of Damage:	Slight / Minor Damage	1
Surface Treatment:	Unsealed Cement	1
Asbestos type:	Chrysotile	1
Material Assessment Score:		4
Priority Assessment Score:		Negligible
Action:	Manage	
Comments:	3 x Pipes. Previously sampled ref: Armour 2/10/19 - Sample DK/11	

Document Name	Author	Issued by	Revision Number	Issue Date	Page No
2020	David Kelly	Armour AS	0	02/12/2020	18

Item No:	14	Sample No:	N/A
Location:	External - Drill Hall 014		



Material Description:	Profiled Roof - Cement Product	
Identification:	Presumed to Contain Asbestos	
Approx. quantity:	200 m ²	
Accessibility	Difficult	<i>Assessment Score</i>
Product type:	Cement	1
Extent of Damage:	Minor Damage	1
Surface Treatment:	Sealed Cement	1
Asbestos type:	Chrysotile	1
Material Assessment Score:		4
Priority Assessment Score:		Negligible
Action:	Manage	
Comments:	No access to sample due to height	

Document Name	Author	Issued by	Revision Number	Issue Date	Page No
2020	David Kelly	Armour AS	0	02/12/2020	19

Item No:	15	Sample No:	N/A
Location:	External - Drill Hall 015		



Material Description:	Roof Edging - Cement Product	
Identification:	Presumed to Contain Asbestos	
Approx. quantity:	36 LM	
Accessibility	Difficult	<i>Assessment Score</i>
Product type:	Cement	1
Extent of Damage:	Minor Damage	1
Surface Treatment:	Sealed Cement	1
Asbestos type:	Chrysotile	1
Material Assessment Score:		4
Priority Assessment Score:		Negligible
Action:	Manage	
Comments:	No access to sample due to height	

Document Name	Author	Issued by	Revision Number	Issue Date	Page No
2020	David Kelly	Armour AS	0	02/12/2020	20

Item No:	16	Sample No:	N/A
Location:	External - RGH Office 016		



Material Description:	Profiled Roof - Cement Product	
Identification:	Previously Sampled - Asbestos Detected	
Approx. quantity:	6 m ²	
Accessibility	Difficult	<i>Assessment Score</i>
Product type:	Cement	1
Extent of Damage:	Slight / Minor Damage	1
Surface Treatment:	Unsealed Cement	1
Asbestos type:	Chrysotile	1
Material Assessment Score:		4
Priority Assessment Score:		Negligible
Action:	Manage	
Comments:	Previously sampled ref: Armour 2/10/19 - Sample DK/13	

Document Name	Author	Issued by	Revision Number	Issue Date	Page No
2020	David Kelly	Armour AS	0	02/12/2020	21

Item No:	17	Sample No:	N/A
Location:	External - RGH Office 017		



Material Description:	Roof Edging - Cement Product	
Identification:	Previously Sampled - Asbestos Detected	
Approx. quantity:	2 LM	
Accessibility	Difficult	<i>Assessment Score</i>
Product type:	Cement	1
Extent of Damage:	Slight / Minor Damage	1
Surface Treatment:	Unsealed Cement	1
Asbestos type:	Chrysotile	1
Material Assessment Score:		4
Priority Assessment Score:		Negligible
Action:	Manage	
Comments:	Previously sampled ref: Armour 2/10/19 - Sample DK/14	

Document Name	Author	Issued by	Revision Number	Issue Date	Page No
2020	David Kelly	Armour AS	0	02/12/2020	22

Item No:	18	Sample No:	N/A
Location:	External - Training Room 018		



Material Description:	Roof Tiles - Cement Product	
Identification:	Previously Sampled - Asbestos Detected	
Approx. quantity:	60 m ²	
Accessibility	Difficult	<i>Assessment Score</i>
Product type:	Cement	1
Extent of Damage:	Slight / Minor Damage	1
Surface Treatment:	Unsealed Cement	1
Asbestos type:	Chrysotile	1
Material Assessment Score:		4
Priority Assessment Score:		Negligible
Action:	Manage	
Comments:	Previously sampled ref: Armour 2/10/19 - Sample DK/15	

Document Name	Author	Issued by	Revision Number	Issue Date	Page No
2020	David Kelly	Armour AS	0	02/12/2020	23

Item No:	19	Sample No:	N/A
Location:	Ground Floor - Gym Block - Store 019		



Material Description:	Floor Tiles and Adhesive - Vinyl Products	
Identification:	Previously Sampled - Asbestos Detected	
Approx. quantity:	30 m ²	
Accessibility	Easy	<i>Assessment Score</i>
Product type:	Vinyl	1
Extent of Damage:	Slight / Minor Damage	1
Surface Treatment:	Non-Friable	0
Asbestos type:	Chrysotile	1
Material Assessment Score:		3
Priority Assessment Score:		Negligible
Action:	Manage	
Comments:	Previously sampled ref: Armour 2/10/19 - Sample DK/17	

Document Name	Author	Issued by	Revision Number	Issue Date	Page No
2020	David Kelly	Armour AS	0	02/12/2020	24

Item No:	20	Sample No:	N/A
Location:	First Floor - Cadet Area - Landing 020		



Material Description:	Red and Brown Floor Tiles and Adhesive - Vinyl Products	
Identification:	Previously Sampled - Asbestos Detected	
Approx. quantity:	6 m ²	
Accessibility	Easy	<i>Assessment Score</i>
Product type:	Vinyl	1
Extent of Damage:	Moderate Damage	2
Surface Treatment:	Non-Friable	0
Asbestos type:	Chrysotile	1
Material Assessment Score:		4
Priority Assessment Score:		Negligible
Action:	Manage	
Comments:	Previously sampled ref: Armour 2/10/19 - Sample DK/19	

Document Name	Author	Issued by	Revision Number	Issue Date	Page No
2020	David Kelly	Armour AS	0	02/12/2020	25

Item No:	21	Sample No:	N/A
Location:	First Floor - Cadet Area - Cupboard and WC 021		



Material Description:	Red and Brown Floor Tiles and Adhesive - Vinyl Products	
Identification:	Previously Sampled - Asbestos Detected	
Approx. quantity:	6 m ²	
Accessibility	Easy	<i>Assessment Score</i>
Product type:	Vinyl	1
Extent of Damage:	Minor Damage	1
Surface Treatment:	Non-Friable	0
Asbestos type:	Chrysotile	1
Material Assessment Score:		3
Priority Assessment Score:		Negligible
Action:	Manage	
Comments:	Previously sampled ref: Armour 2/10/19 - Sample DK/19	

Document Name	Author	Issued by	Revision Number	Issue Date	Page No
2020	David Kelly	Armour AS	0	02/12/2020	26

Item No: 22

Sample No: N/A

Location: First Floor - Cadet Area - Office 022



Material Description:	Red and Brown Floor Tiles and Adhesive - Vinyl Products	
Identification:	Previously Sampled - Asbestos Detected	
Approx. quantity:	15 m ²	
Accessibility	Difficult	<i>Assessment Score</i>
Product type:	Vinyl	1
Extent of Damage:	Minor Damage	1
Surface Treatment:	Non-Friable	0
Asbestos type:	Chrysotile	1
Material Assessment Score:		3
Priority Assessment Score:		Negligible
Action:	Manage	
Comments:	Under carpet. Previously sampled ref: Armour 2/10/19 - Sample DK/19	

Document Name	Author	Issued by	Revision Number	Issue Date	Page No
2020	David Kelly	Armour AS	0	02/12/2020	27

Item No:	23	Sample No:	N/A
Location:	First Floor - Cadet Area - Store and Cupboard 023		

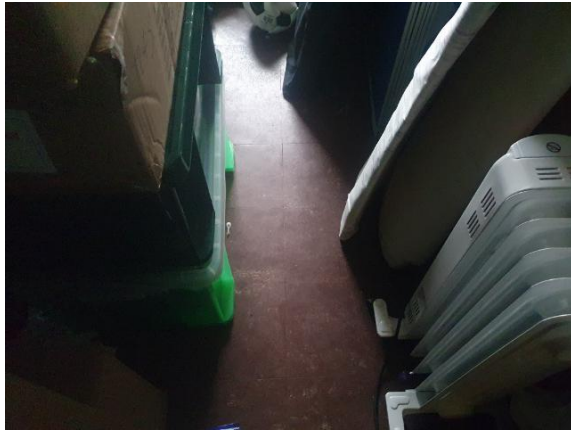

Material Description:	Floor Tiles and Adhesive - Vinyl Products	
Identification:	Previously Sampled - Asbestos Detected	
Approx. quantity:	19 m ²	
Accessibility	Easy	<i>Assessment Score</i>
Product type:	Vinyl	1
Extent of Damage:	Minor Damage	1
Surface Treatment:	Non-Friable	0
Asbestos type:	Chrysotile	1
Material Assessment Score:		3
Priority Assessment Score:		Negligible
Action:	Manage	
Comments:	Under carpet. Previously sampled ref: Armour 2/10/19 - Sample DK/19	

Document Name	Author	Issued by	Revision Number	Issue Date	Page No
2020	David Kelly	Armour AS	0	02/12/2020	28

Item No: 24

Sample No: N/A

Location: First Floor - Cadet Area - Medical Officer Room 024



Material Description:	Floor Tiles and Adhesive - Vinyl Products	
Identification:	Previously Sampled - Asbestos Detected	
Approx. quantity:	12 m ²	
Accessibility	Difficult	<i>Assessment Score</i>
Product type:	Vinyl	1
Extent of Damage:	Minor Damage	1
Surface Treatment:	Non-Friable	0
Asbestos type:	Chrysotile	1
Material Assessment Score:		3
Priority Assessment Score:		Negligible
Action:	Manage	
Comments:	Under carpet. Previously sampled ref: Armour 2/10/19 - Sample DK/21	

Document Name	Author	Issued by	Revision Number	Issue Date	Page No
2020	David Kelly	Armour AS	0	02/12/2020	29

Item No:	25	Sample No:	N/A
Location:	External - Main Building 025		



Material Description:	Downpipes - Cement Product	
Identification:	Previously Sampled - Asbestos Detected	
Approx. quantity:	25 LM	
Accessibility	Difficult	<i>Assessment Score</i>
Product type:	Cement	1
Extent of Damage:	Slight / Minor Damage	1
Surface Treatment:	Unsealed Cement	1
Asbestos type:	Chrysotile	1
Material Assessment Score:		4
Priority Assessment Score:		Negligible
Action:	Manage	
Comments:	5 x Pipes. Previously sampled ref: Armour 2/10/19 - Sample DK/22	

Document Name	Author	Issued by	Revision Number	Issue Date	Page No
2020	David Kelly	Armour AS	0	02/12/2020	30

Item No:	26	Sample No:	N/A
Location:	External - Drill Hall 026		



Material Description:	Guttering - Cement Product	
Identification:	Previously Sampled - Asbestos Detected	
Approx. quantity:	12 LM	
Accessibility	Difficult	<i>Assessment Score</i>
Product type:	Cement	1
Extent of Damage:	Slight / Minor Damage	1
Surface Treatment:	Unsealed Cement	1
Asbestos type:	Chrysotile	1
Material Assessment Score:		4
Priority Assessment Score:		Negligible
Action:	Manage	
Comments:	2 x Pipes. Previously sampled ref: Armour 2/10/19 - Sample DK/22	

Document Name	Author	Issued by	Revision Number	Issue Date	Page No
2020	David Kelly	Armour AS	0	02/12/2020	31

Item No:	27	Sample No:	N/A
Location:	External - Drill Hall 027		



Material Description:	Soffits - Insulating Board	
Identification:	Presumed to Contain Asbestos	
Approx. quantity:	22 LM	
Accessibility	Difficult	<i>Assessment Score</i>
Product type:	Asbestos Insulating Board	2
Extent of Damage:	Minor Damage	1
Surface Treatment:	Unsealed AIB	2
Asbestos type:	Amosite	2
Material Assessment Score:		7
Priority Assessment Score:		Medium
Action:	Manage	
Comments:	No access to sample due to height	

Document Name	Author	Issued by	Revision Number	Issue Date	Page No
2020	David Kelly	Armour AS	0	02/12/2020	32

Item No:	28	Sample No:	N/A
Location:	External - Main Building 028		



Material Description:	Undercloaking to Gable Ends - Cement Product	
Identification:	Presumed to Contain Asbestos	
Approx. quantity:	20 LM	
Accessibility	Difficult	<i>Assessment Score</i>
Product type:	Cement	1
Extent of Damage:	Minor Damage	1
Surface Treatment:	Unsealed Cement	1
Asbestos type:	Chrysotile	1
Material Assessment Score:		4
Priority Assessment Score:		Negligible
Action:	Manage	
Comments:	No access to sample due to height	

Document Name	Author	Issued by	Revision Number	Issue Date	Page No
2020	David Kelly	Armour AS	0	02/12/2020	33

Item No: 29

Sample No: N/A

Location: External - Main Building Porch 029



Material Description:	Roof Tiles - Cement Product	
Identification:	Previously Sampled - Asbestos Detected	
Approx. quantity:	2 m ²	
Accessibility	Difficult	<i>Assessment Score</i>
Product type:	Cement	1
Extent of Damage:	Minor Damage	1
Surface Treatment:	Unsealed Cement	1
Asbestos type:	Chrysotile	1
Material Assessment Score:		4
Priority Assessment Score:		Negligible
Action:	Manage	
Comments:	Previously sampled ref: Armour 2/10/19 - Sample DK/23	

Document Name	Author	Issued by	Revision Number	Issue Date	Page No
2020	David Kelly	Armour AS	0	02/12/2020	34

Item No:	31	Sample No:	N/A
Location:	First Floor - Garage Block - Store and Mezzanine 031		



Material Description:	Night Storage Heater - No Access Gained	
Identification:	Presumed to Contain Asbestos	
Approx. quantity:	2 no	
Accessibility	Difficult	<i>Assessment Score</i>
Product type:	Asbestos Insulating Board	2
Extent of Damage:	Major Damage	3
Surface Treatment:	Unsealed AIB	2
Asbestos type:	Amosite	2
Material Assessment Score:		9
Priority Assessment Score:		Medium
Action:	Manage	
Comments:	No access as live	

Document Name	Author	Issued by	Revision Number	Issue Date	Page No
2020	David Kelly	Armour AS	0	02/12/2020	35

Item No:	32	Sample No:	N/A
Location:	External - Garage Block - Garages 032		



Material Description:	Profiled Roof - Cement Product	
Identification:	Presumed to Contain Asbestos	
Approx. quantity:	360 m ²	
Accessibility	Difficult	<i>Assessment Score</i>
Product type:	Cement	1
Extent of Damage:	Minor Damage	1
Surface Treatment:	Unsealed Cement	1
Asbestos type:	Chrysotile	1
Material Assessment Score:		4
Priority Assessment Score:		Negligible
Action:	Manage	
Comments:	No access to sample due to height	

Document Name	Author	Issued by	Revision Number	Issue Date	Page No
2020	David Kelly	Armour AS	0	02/12/2020	36

Item No:	33	Sample No:	N/A
Location:	External - Garage Block - Garages 033		



Material Description:	Roof Edging - Cement Product	
Identification:	Presumed to Contain Asbestos	
Approx. quantity:	16 LM	
Accessibility	Difficult	<i>Assessment Score</i>
Product type:	Cement	1
Extent of Damage:	Minor Damage	1
Surface Treatment:	Unsealed Cement	1
Asbestos type:	Chrysotile	1
Material Assessment Score:		4
Priority Assessment Score:		Negligible
Action:	Manage	
Comments:	No access to sample due to height	

Document Name	Author	Issued by	Revision Number	Issue Date	Page No
2020	David Kelly	Armour AS	0	02/12/2020	37

Item No: 34

Sample No: N/A

Location: External - Main Block 034



Material Description:	Roof Tiles - Cement Product	
Identification:	Presumed to Contain Asbestos	
Approx. quantity:	80 m ²	
Accessibility	Difficult	<i>Assessment Score</i>
Product type:	Cement	1
Extent of Damage:	Minor Damage	1
Surface Treatment:	Unsealed Cement	1
Asbestos type:	Chrysotile	1
Material Assessment Score:		4
Priority Assessment Score:		Negligible
Action:	Manage	
Comments:	No access to sample due to height	

Document Name	Author	Issued by	Revision Number	Issue Date	Page No
2020	David Kelly	Armour AS	0	02/12/2020	38

Section 5: Negative Items

Item No:	10	Sample No:	N/A
Location:	Ground Floor - Armoury 010		



Material Description:	No Suspect Materials Found	
Identification:	N/A	
Approx. quantity:	N/A	
Accessibility	N/A	<i>Assessment Score</i>
Product type:	N/A	N/A
Extent of Damage:	N/A	N/A
Surface Treatment:	N/A	N/A
Asbestos type:	N/A	N/A
Material Assessment Score:		
Priority Assessment Score:		
Action:	N/A	
Comments:	Previously un-accessed area. Now accessed and no asbestos found. Brick walls and concrete floor and ceiling	

Document Name	Author	Issued by	Revision Number	Issue Date	Page No
2020	David Kelly	Armour AS	0	02/12/2020	39

Item No:	13	Sample No:	N/A
Location:	Ground Floor - Ammo Store 013		



Material Description:	No Suspect Materials Found	
Identification:	N/A	
Approx. quantity:	N/A	
Accessibility	N/A	<i>Assessment Score</i>
Product type:	N/A	N/A
Extent of Damage:	N/A	N/A
Surface Treatment:	N/A	N/A
Asbestos type:	N/A	N/A
Material Assessment Score:		
Priority Assessment Score:		
Action:	N/A	
Comments:	Previously un-accessed area. Now accessed and no asbestos found. Brick walls and concrete floor and ceiling	

Document Name	Author	Issued by	Revision Number	Issue Date	Page No
2020	David Kelly	Armour AS	0	02/12/2020	40

Item No:	30	Sample No:	N/A
Location:	First Floor - Cadet Area - Store Room 030		



Material Description:	No Suspect Materials Found	
Identification:	N/A	
Approx. quantity:	N/A	
Accessibility	N/A	<i>Assessment Score</i>
Product type:	N/A	N/A
Extent of Damage:	N/A	N/A
Surface Treatment:	N/A	N/A
Asbestos type:	N/A	N/A
Material Assessment Score:		
Priority Assessment Score:		
Action:	N/A	
Comments:	Not accessed in previous survey as key as not available. Now accessed and no asbestos was found. Plasterboard walls and ceiling and non-asbestos electric heater.	

Document Name	Author	Issued by	Revision Number	Issue Date	Page No
2020	David Kelly	Armour AS	0	02/12/2020	41

Item No:	35	Sample No:	N/A
Location:	Basement - Boiler Room 035		

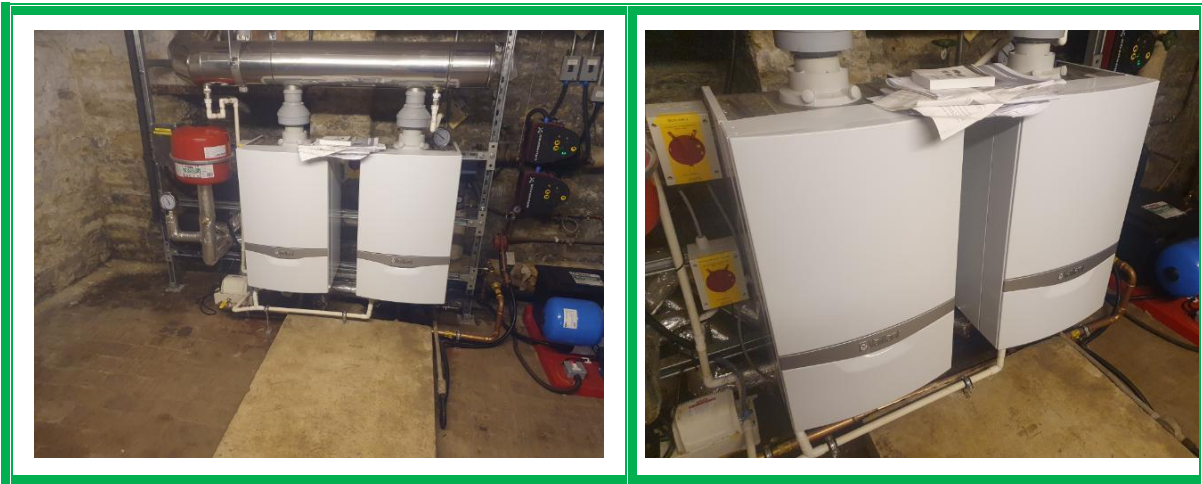

Material Description:	No Suspect Materials Found	
Identification:	N/A	
Approx. quantity:	N/A	
Accessibility	N/A	<i>Assessment Score</i>
Product type:	N/A	N/A
Extent of Damage:	N/A	N/A
Surface Treatment:	N/A	N/A
Asbestos type:	N/A	N/A
Material Assessment Score:		
Priority Assessment Score:		
Action:	N/A	
Comments:	Boilers have been replaced with modern Vaillant boilers.	

Document Name	Author	Issued by	Revision Number	Issue Date	Page No
2020	David Kelly	Armour AS	0	02/12/2020	42

Section 6: Survey Objectives

Instructions were received from Kelvin Walker of Wessex RFCA to carry out a Re-Inspection asbestos survey at Royal Wessex Yeomanry C, Gloucestershire, GL7 1TT in accordance with HSG264 and Armour Analytical's quality procedures.

The survey was carried out on 29 November 2020 by David Kelly with the objective of facilitating a Management report.

Document Name	Author	Issued by	Revision Number	Issue Date	Page No
2020	David Kelly	Armour AS	0	02/12/2020	43

Section 7: Survey Notes

This report has been written with reference to the various Guidance Notes etc, issued, and current at the date of this report and describes circumstances at the site on the date the investigation took place.

Where similar items exist in the building, only one or two samples may have been taken to ascertain the material content. It was assumed that similar products were of the same material.

Any person undertaking work within the buildings should be told of the presence of asbestos. This briefing also applies to any other person associated with the site, including staff, sub-contractors and others.

The drawings in the report are not to scale and are illustrative only to indicate approximate locations. The descriptions used are for location identification purposes.

All the recommendations described in this report are based upon assumptions made after consideration of the type of material, condition of the material, its location, analysis result and type of use the area is thought to be subjected to. However, statutory authorities or others could require amendments based on local knowledge, change in legislation, change in use or indeed other conditions or criteria.

Samples taken from floor tiles (or similar material) may include a bitumen adhesive as part of the sample. It is known that some proprietary brands of bitumen have an asbestos content and this will be included as an integral part of the bulk sample unless otherwise stated.

Document Name	Author	Issued by	Revision Number	Issue Date	Page No
2020	David Kelly	Armour AS	0	02/12/2020	44

Section 8: Material Assessment Algorithm

Variable	Score	Examples
Installation / Product type	1	Vinyl, 'Bakelite', Cement
	2	Asbestos Insulating Board, Paper, Rope
	3	Pipe Insulation, Spray Coating, Friable Debris
Condition / damage	0	Good
	1	Slight / Minor Damage
	2	Moderate Damage – Breakage To Surface Treatment
	3	Major Damage – Smashed Or Exposed Material
Surface treatment	0	Non-Friable E.G. Vinyl
	1	Enclosed Insulation, Rope Seal, Encapsulated AIB
	2	Unsealed AIB, Encapsulated Insulation
	3	Unsealed Insulation, Spray Coating
Asbestos type	1	Chrysotile
	2	Amosite and Other Amphiboles
	3	Crocidolite

The scores from each of the four sections are added together to produce a risk score:

Risk score	Risk assessment
10 or more	High risk
7 – 9	Medium risk
5 – 6	Low risk
4 and below	Negligible risk



Section 9: Certificates of Bulk Analysis





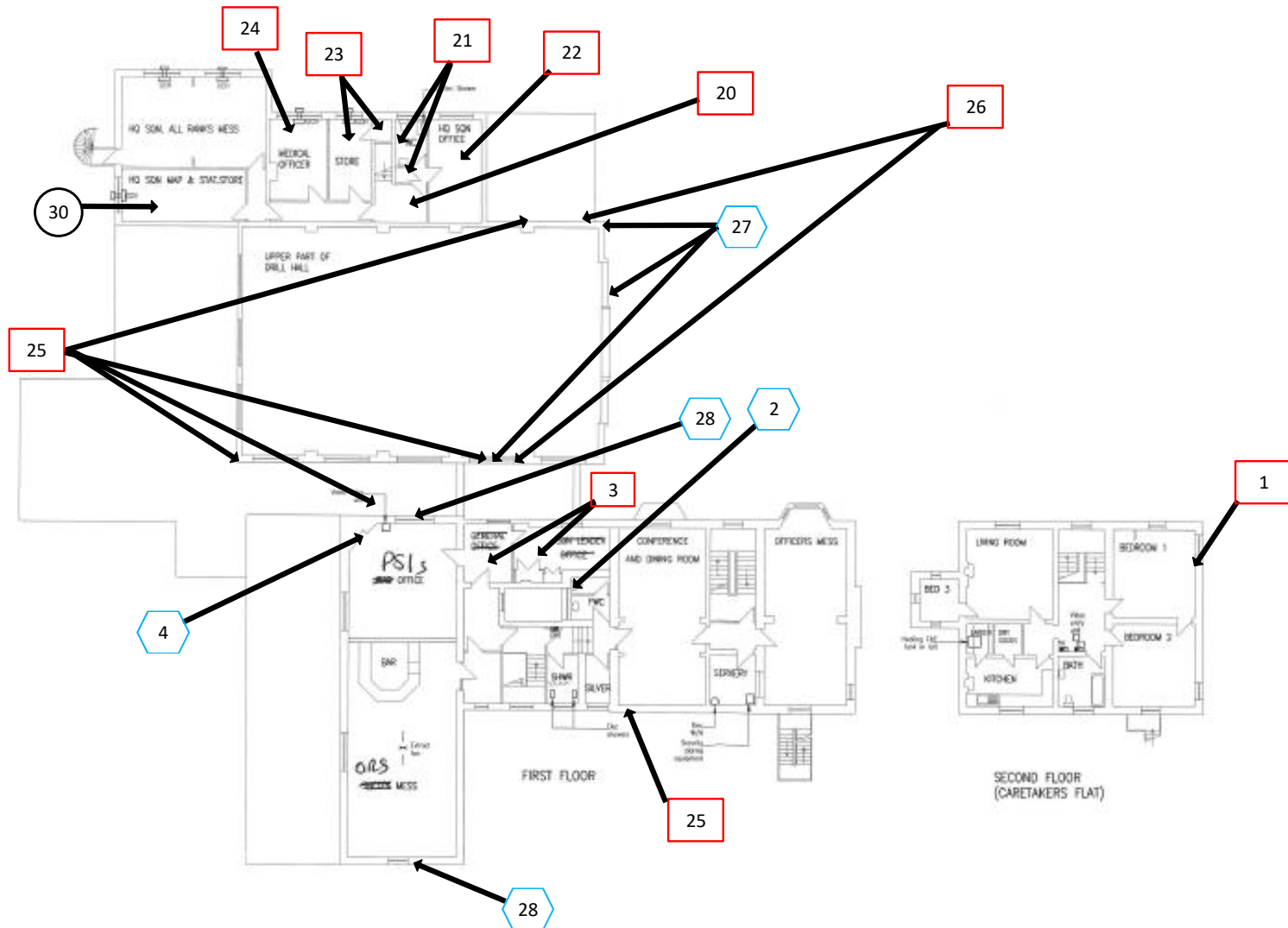

No samples were taken during this survey.

Document Name	Author	Issued by	Revision Number	Issue Date	Page No
2020	David Kelly	Armour AS	0	02/12/2020	46

Section 10: Site Plan

Second & First Floor







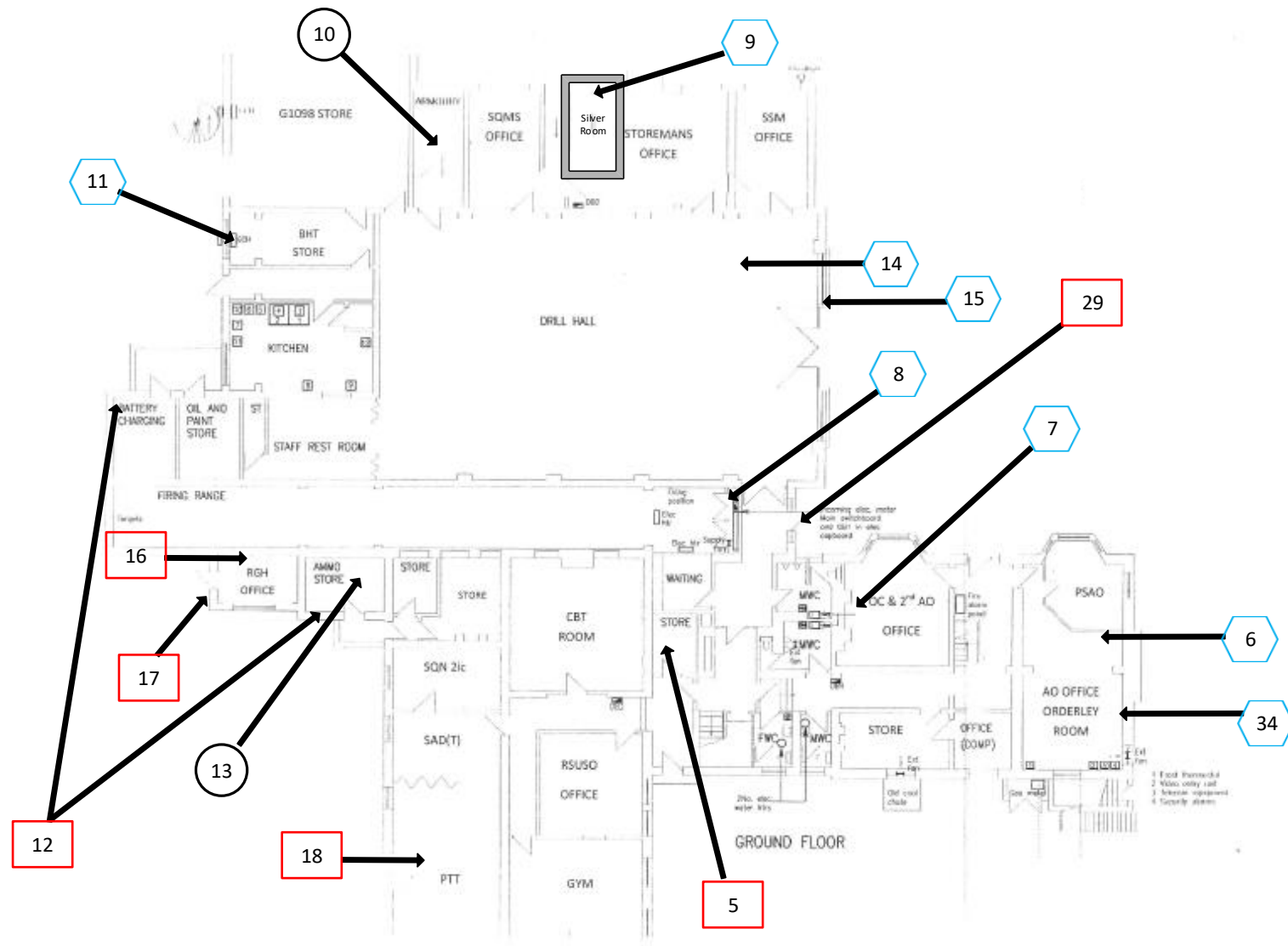

Key	
	Visual Inspection
	Asbestos Detected (Positive Item)
	No Asbestos Detected (Negative Item)
	Presumed to Contain Asbestos
	Strongly Presumed to Contain Asbestos
	No Access

Document Name	Author	Issued by	Revision Number	Issue Date	Page No
2020	David Kelly	Armour AS	0	02/12/2020	47

Ground Floor







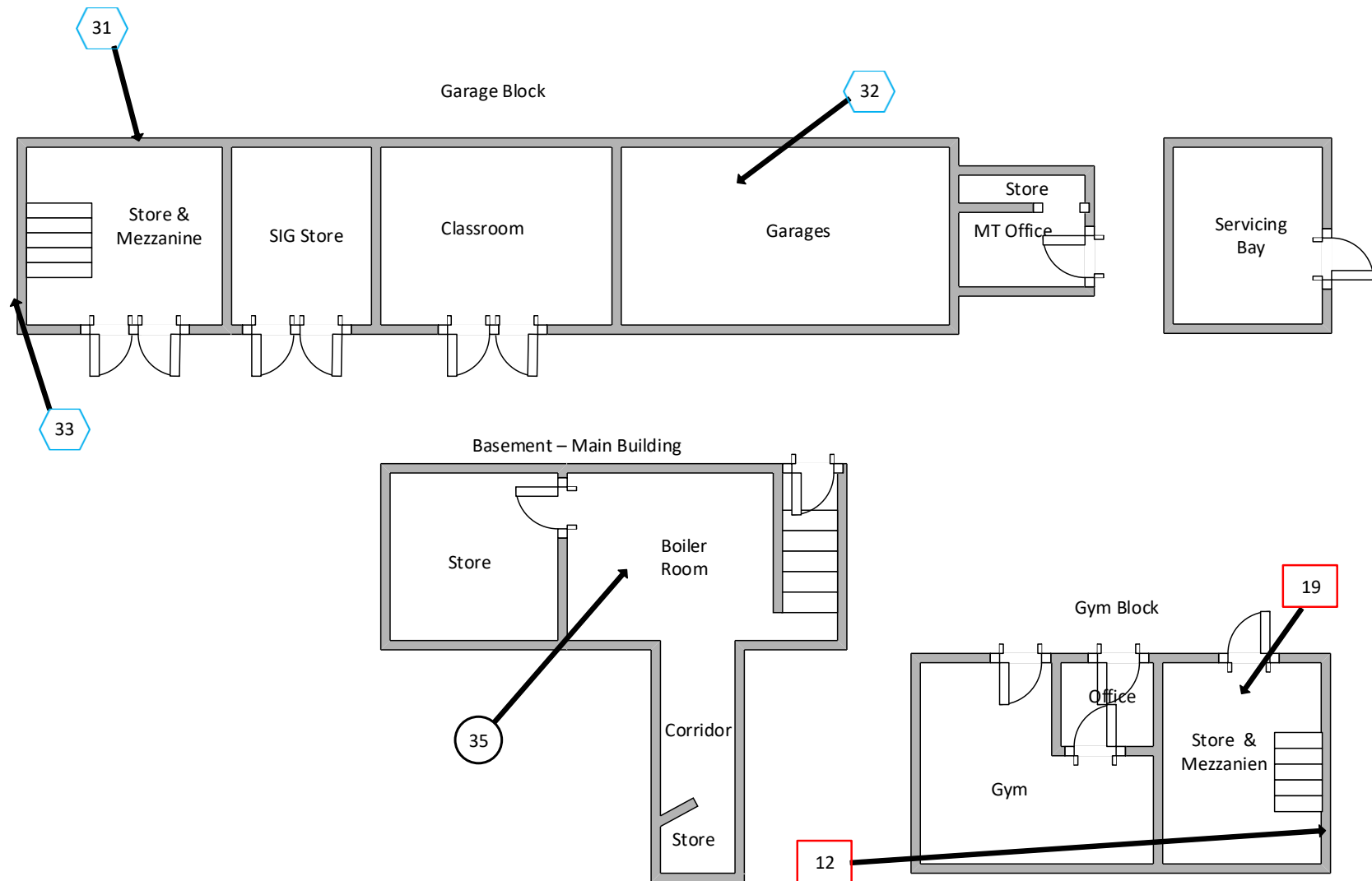

Key	
	Visual Inspection
	Asbestos Detected (Positive Item)
	No Asbestos Detected (Negative Item)
	Presumed to Contain Asbestos
	Strongly Presumed to Contain Asbestos
	No Access

Document Name	Author	Issued by	Revision Number	Issue Date	Page No
2020	David Kelly	Armour AS	0	02/12/2020	48

Outbuildings



Key	
	Visual Inspection
	Asbestos Detected (Positive Item)
	No Asbestos Detected (Negative Item)
	Presumed to Contain Asbestos
	Strongly Presumed to Contain Asbestos
	No Access

Document Name	Author	Issued by	Revision Number	Issue Date	Page No
2020	David Kelly	Armour AS	0	02/12/2020	49



I the surveyor can confirm that this report is accurate to my findings onsite and this survey has been Content checked by myself.

Checked by: David Kelly

Date: 01/12/2020

I the Admin Manager can confirm that this report is accurate to the paperwork received and this survey has been quality checked by myself.

Checked by: Emma Humphreys

Date: 01.12.2020

Report Compiled By

Armour Analytical Services Ltd, Admirals Yard, Station Road, Bristol, BS34 6LR

Document Name	Author	Issued by	Revision Number	Issue Date	Page No
2020	David Kelly	Armour AS	0	02/12/2020	50