

Project Number 3700

Re-Inspection
Asbestos Survey Report - Revised

St Blazey Platoon
Cornwall
PL24 2NF



Working in Partnership with Shield Services Group



Document Name	Author	Issued by	Revision Number	Issue Date	Page No
2021	David Kelly	Armour AS	0	14/10/2021	1

Contents

Section	
1	Contact Details
2	Executive Summary
3	Site Description & Survey Information
4	Positive, Presumed or No Access Items
5	Negative Photos Sheets
6	Survey Objectives
7	Survey Notes
8	Material Assessment Algorithm
9	Certificates of Bulk Analysis
10	Site Plan

Document Name	Author	Issued by	Revision Number	Issue Date	Page No
2021	David Kelly	Armour AS	0	14/10/2021	2



Section 1: Contact Details

Client Details:		Instructing Party:	
Wessex RFCA Mount House Mount Street Taunton TA1 3QE		Wessex RFCA Mount House Mount Street Taunton TA1 3QE	
Contact Name:	Kelvin Walker	Contact Name:	Kelvin Walker
Tel: 01823 250116	Fax: N/A	Tel: 01823 250116	Fax: N/A

Site Address:		Report Author:	
St Blazey Platoon Cornwall PL24 2NF		Armour Analytical Services Admirals Yard Station Road Bristol BS34 6LR	
Contact Name:	Russ Wilkinson	Contact Name:	Andrea Bansee
Tel: 07850 024694	Fax: N/A	Mobile: 07468 535 836	

Lead Surveyor's Name:	Lead Surveyor's Authorising Signature:
David Kelly	

Document Name	Author	Issued by	Revision Number	Issue Date	Page No
2021	David Kelly	Armour AS	0	14/10/2021	3



Section 2: Executive Summary

No samples were taken during this survey.

Document Name	Author	Issued by	Revision Number	Issue Date	Page No
2021	David Kelly	Armour AS	0	14/10/2021	4

Section 3: Site Description & Survey Information

Brief description on the general building construction

Pebble-dashed blockwork construction with flat felt and pitched profiled cement roofs.

Caveat for no access areas

All areas accessed.

EXTERNAL MATERIALS

Roof Type	Flat, Pitched
Roof Materials	Felt, Profiled Cement
Soffits	Timber
Fascia	Timber
Walls	Blockwork
Verge Under cloaking	N/A
Guttering	Plastic
Downpipes	Plastic
Window/Door frames	Timber
Other Materials	N/A

INTERNAL MATERIALS

Loft Insulation	Fiberglass
Roof Underlining	N/A
Ceilings	Plasterboard, Fibreboard, Suspended
Walls <i>Internal</i>	Plasterboard, Block, Supalux
Floors	Carpet, Lino, Tiles, Concrete
Doors/Frames	Timber
Pipework/Insulation	Copper
Boxings	Plasterboard
Boiler Make	N/A
Flue Pipes	N/A
Storage Heaters	Modern
Electrical Boxes/Machinery	Modern
Ducting/Risers	N/A
Stairs	N/A
Lift Shafts	N/A
Other Materials	N/A

Document Name	Author	Issued by	Revision Number	Issue Date	Page No
2021	David Kelly	Armour AS	0	14/10/2021	5



Section 4: Positive, Presumed or No Access Items

No positive presumed or no access items were found during this survey.

Document Name	Author	Issued by	Revision Number	Issue Date	Page No
2021	David Kelly	Armour AS	0	14/10/2021	6

Section 5: Negative Items

Item No:	1	Sample No:	N/A
Location:	Ground Floor – Ground Floor ATC Store - 001		

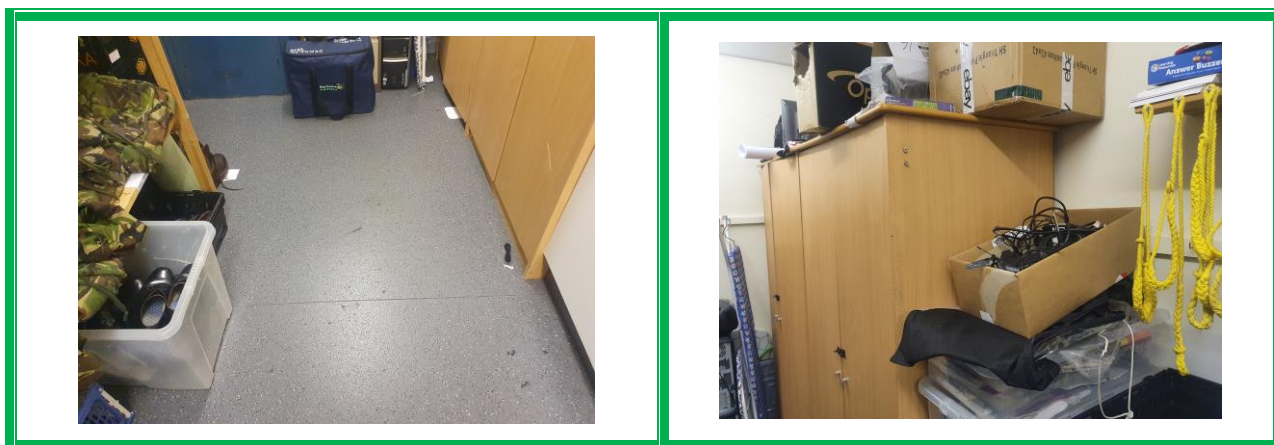

Material Description:	No Suspect Materials Found	
Identification:	N/A	
Approx. quantity:	N/A	
Accessibility	N/A	Assessment Score
Product type:	N/A	N/A
Extent of Damage:	N/A	N/A
Surface Treatment:	N/A	N/A
Asbestos type:	N/A	N/A
Material Assessment Score:		N/A
Priority Assessment Score:		N/A
Action:	N/A	
Comments:	<p>Previously a no access area. Now accessed and no asbestos found.</p> <p>Plasterboard/blockwork walls, lino flooring, modern ceiling tiles.</p>	

Document Name	Author	Issued by	Revision Number	Issue Date	Page No
2021	David Kelly	Armour AS	0	14/10/2021	7



Section 6: Survey Objectives

Instructions were received from Kelvin Walker of Wessex RFCA to carry out a Re-Inspection asbestos survey at St Blazey Platoon, Cornwall, PL24 2NF in accordance with HSG264 and Armour Analytical's quality procedures.

The survey was carried out on 10 March 2021 by David Kelly with the objective of facilitating a Re-Inspection report.

Survey, with the objective of accessing previously no accessed areas, carried out on 12 October 2021 by David Kelly.

Document Name	Author	Issued by	Revision Number	Issue Date	Page No
2021	David Kelly	Armour AS	0	14/10/2021	8



Section 7: Survey Notes

This report has been written with reference to the various Guidance Notes etc, issued, and current at the date of this report and describes circumstances at the site on the date the investigation took place.

Where similar items exist in the building, only one or two samples may have been taken to ascertain the material content. It was assumed that similar products were of the same material.

Any person undertaking work within the buildings should be told of the presence of asbestos. This briefing also applies to any other person associated with the site, including staff, sub-contractors and others.

The drawings in the report are not to scale and are illustrative only to indicate approximate locations. The descriptions used are for location identification purposes.

All the recommendations described in this report are based upon assumptions made after consideration of the type of material, condition of the material, its location, analysis result and type of use the area is thought to be subjected to. However, statutory authorities or others could require amendments based on local knowledge, change in legislation, change in use or indeed other conditions or criteria.

Samples taken from floor tiles (or similar material) may include a bitumen adhesive as part of the sample. It is known that some proprietary brands of bitumen have an asbestos content and this will be included as an integral part of the bulk sample unless otherwise stated.

Due to the artex being non-homogenous, it is recommended to treat all areas as containing asbestos if you have a positive sample of artex.

Document Name	Author	Issued by	Revision Number	Issue Date	Page No
2021	David Kelly	Armour AS	0	14/10/2021	9

Section 8: Material Assessment Algorithm

Variable	Score	Examples
Product type	1	Vinyl, 'Bakelite', Cement, Textured Coating, Non-Friable Debris, Floor Tiles, Bitumen, Reinforced Plastics, Mastic (putty), Windowsills
	2	Asbestos Insulating Board, Paper, Rope, Burned Cement Debris, Flashguards, Gaskets
	3	Pipe Insulation, Spray Coating, Friable Debris, Loose Fill Asbestos
Condition / Damage	0	Good
	1	Slight / Minor Damage
	2	Moderate Damage – Breakage to Surface Treatment
	3	Major Damage – Smashed or Exposed Material
Surface Treatment	0	Non-Friable E.G. Vinyl
	1	Enclosed Insulation, Encapsulated AIB, Unsealed Cement, Woven Material, Paper
	2	Unsealed AIB, Encapsulated Insulation, Encapsulated Pipe Lagging
	3	Unsealed Insulation, Spray Coating, Unsealed Pipe Lagging
Asbestos Type	1	Chrysotile
	2	Amosite & Other Amphiboles
	3	Crocidolite

The scores from each of the four sections are added together to produce a risk score:

Risk score	Risk assessment
10 or more	High risk
7 – 9	Medium risk
5 – 6	Low risk
4 & below	Negligible risk







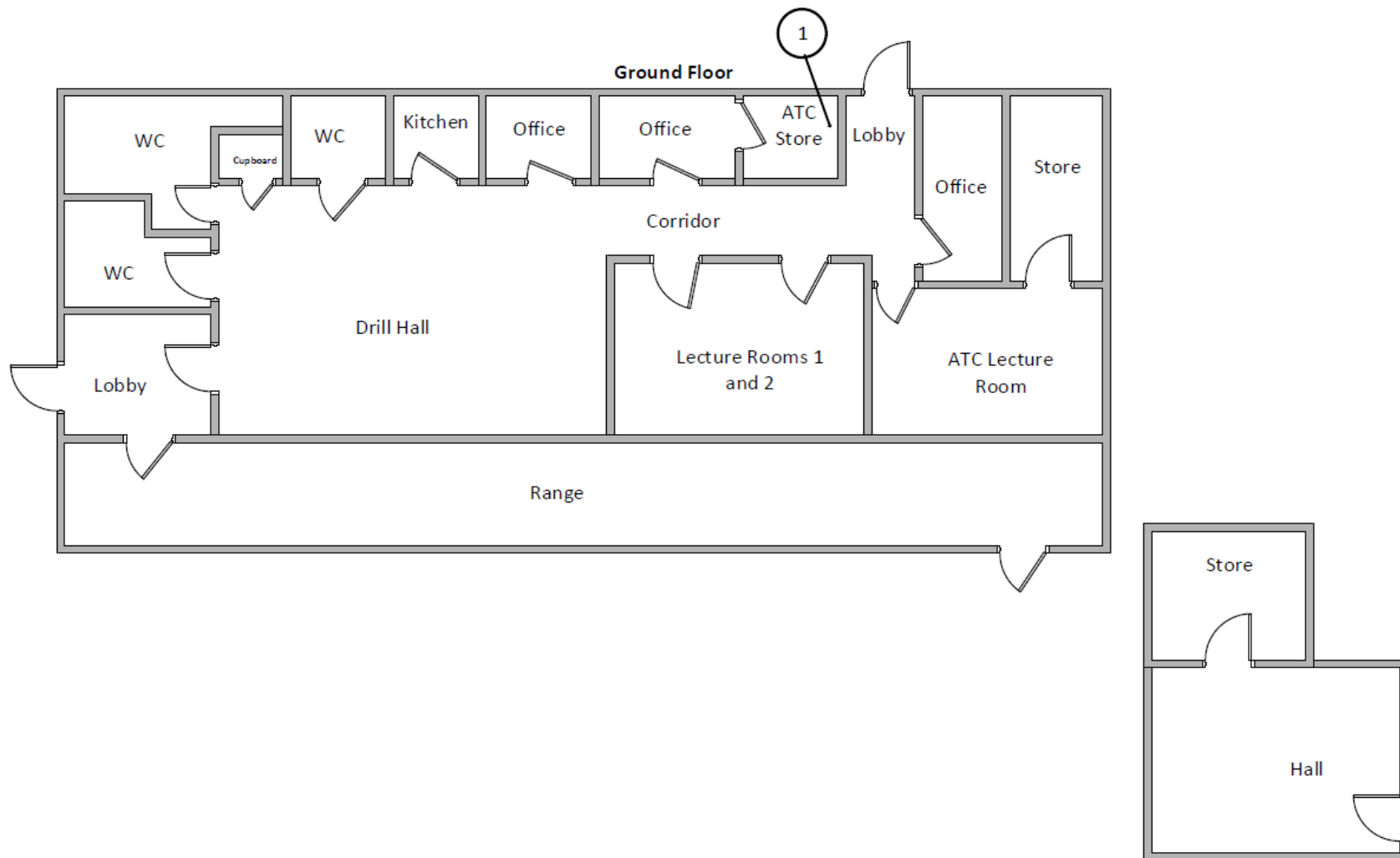

Section 9: Certificates of Bulk Analysis

No samples were taken during this survey.

Document Name	Author	Issued by	Revision Number	Issue Date	Page No
2021	David Kelly	Armour AS	0	14/10/2021	11

Section 10: Site Plan



Key	
	Visual Inspection
	Asbestos Detected (Positive Item)
	No Asbestos Detected (Negative Item)
	Presumed to Contain Asbestos
	Strongly Presumed to Contain Asbestos
	No Access

Document Name	Author	Issued by	Revision Number	Issue Date	Page No
2021	David Kelly	Armour AS	0	14/10/2021	12



I the surveyor can confirm that this report is accurate to my findings onsite and this survey has been Content checked by myself.

Checked by: Will Fyles

Date: 14/10/2021

I the Admin Manager can confirm that this report is accurate to the paperwork received and this survey has been quality checked by myself.

Checked by: Andrea Bansee

Date: 14/10/2021

Report Compiled By

Armour Analytical Services Ltd, Admirals Yard, Station Road, Bristol, BS34 6LR

Document Name	Author	Issued by	Revision Number	Issue Date	Page No
2021	David Kelly	Armour AS	0	14/10/2021	13